

LANGLADE COUNTY U.S. PUBLIC LAND CORNER RESTORATION

The Southeast corner of Section 5, T. 32 N., R. 10 E., Langlade County, WI.

Corner was: (check all that apply)

3210050000

- Restored through acceptance of an obliterated evidence location.
- Restored through acceptance of a found perpetuated location.
- Determined to be lost and re-established through proportionate methods.
- Show bearings and distances to PLSS corners used for proportioning, and show original distances).
- Restored/recovered/re-established in a location that differs from a previously established position.
- (Show difference in plan view below).
- Check here if additional information is shown on the reverse side of this form.

Describe record evidence, recovered physical evidence, occupational evidence, testimonial evidence and all other evidence considered in the recovery/restoration of the corner.

The original corner was established in 1860 by Hiram C. Fellows. Original bearing trees: spruce, 8", S80°E, 36 links, and a fir, 6", N55°W, 25 lks. In 1916, Malcolm Hutchinson found no evidence of this corner and reset it by double proportionate methods between section corners a mile in each direction from this corner. He set a 3" x 3' long iron pipe with cap for the corner. 11/04/99 Dave Tlusty, Tom Arnott found a 3" dia. by 36" long iron pipe with cap on top and plate on the bottom. Pipe as found is frost heaved and leaning. Accepted pipe found as the pipe set by Hutchinson. Straightened it and re-dug it so the top is 0.7' above ground.

Physical description of the monument set:

Re-set the existing 3" x 36" iron pipe. Set a white vinyl sign post 1' SW of the monument.

Describe the accessories used to perpetuate the corner. Include a plan view drawing and accessories found/set. Describe measuring point on bearing trees. Show any topographic features that would aid in future recovery of the corner.

LEGEND

- Bearing trees are measured to a nail in a low blaze on the side of the tree shown.
- BT's painted blue.
- Tie bearings magnetic with hand compass.

old road grade (Kempster Trail)

Field book: FB16-11

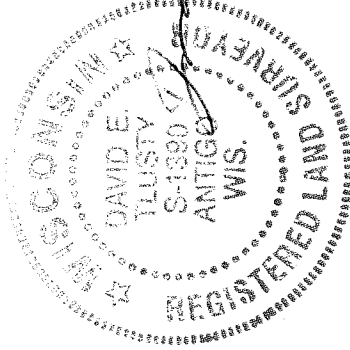
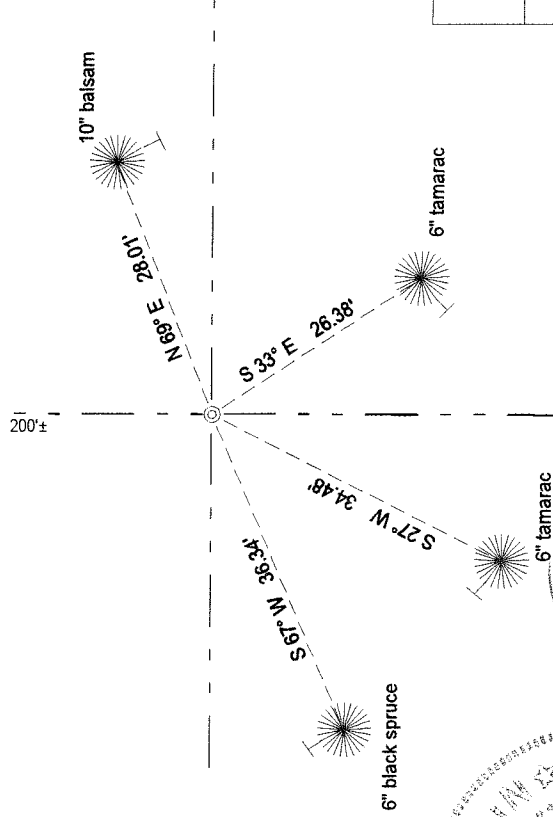
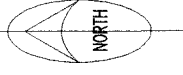

I, David E. Tlusty, Registered Land Surveyor, as Langlade County Surveyor, certify that the corner location on this record was determined by me and that this U.S. Public Land Survey Monument Record is correct to the best of my knowledge and belief.

Index No. E9 32-10

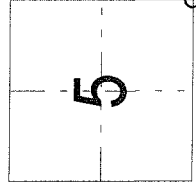

○ = corner perpetuated
The Southeast corner of Section 5, T. 32 N., R. 10 E., Langlade County, WI