

CERTIFIED LAND CORNER RESTORATION

Index No. A-21

State of Wisconsin }
County of Lanlade } ss.

History of original corner establishment:

Corner Established in 1937 Resurvey

I Raymond J. Hallisy, do hereby certify that on the 16th day of April, 1928, I found evidence of the Section corner of 35, 36, 1, 2 Township 31, 32, North, Range 9 EAST, Fourth Principal Meridian, as described hereon; and that from this evidence I established a new monument and accessories as described hereon to perpetuate the original location of this corner.

Description of corner evidence found:

4 inch IRON PIPE WITH BRASS CAP

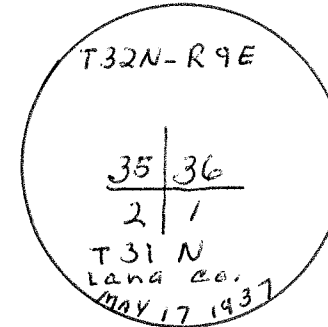

Resident witnesses:

Description of monument and accessories I established to perpetuate the original location of this corner.

NEW B.T.S

- Red MAPLE 9" N78E 12.8 FT,
- ASPEN 10" S62E 18.6 FT
- Red Maple 6" S32W 69.7 FT

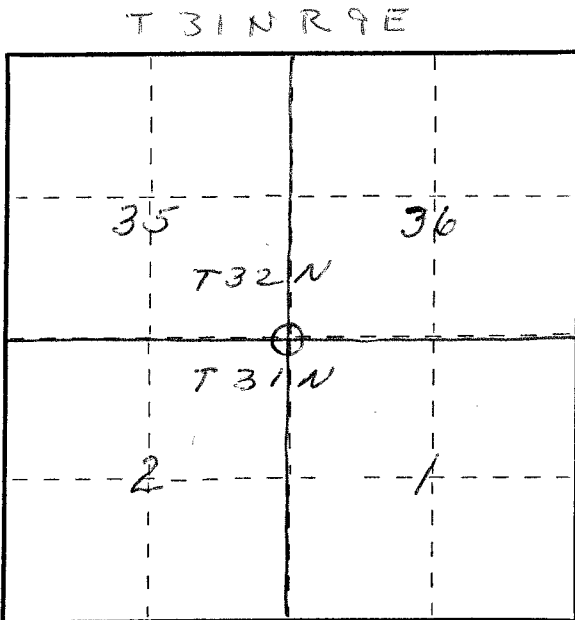

○ = Corner monument restored.

Dated at Antigo, Wis., this 15th day of April, 1928.

Signature Raymond J. Hallisy Title Registered Land Surveyor Registration No. 5-685
(County Surveyor, Registered Land Surveyor, or other duly authorized official)

Office of Register of Deeds, County of _____, I hereby certify that the within instrument was filed in this office for record on the _____ day of _____, 19____ at _____ o'clock _____ M.

(Register of Deeds)

By _____ Deputy

FORM 985 H. C. MILLER CO., MILWAUKEE

43209350000