

CERTIFIED LAND CORNER RESTORATION

Index No. A-7  
31-9

State of Wisconsin }  
County of Langlade } ss.

I, William F. Kelly, do hereby certify that on the 31st day of December, 1979, I found evidence of the South 1/4 corner of Section 32 Township 32, North, Range 9 East, Fourth Principal Meridian, as described hereon; and that from this evidence I established a new monument and accessories as described hereon to perpetuate the original location of this corner.

History of original corner establishment:  
Corner originally set by James Marsh in May, 1851.  
Corner was reset by D. A. Hintz in 1937 resurvey.

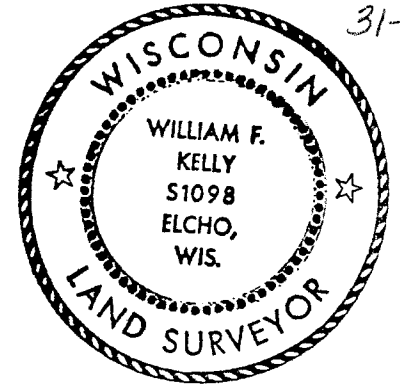

Description of corner evidence found:

Found 4" O.D. iron pipe with brass cap and old B.T. stump. *William F. Kelly*

Resident witnesses:

.....  
.....  
.....

Description of monument and accessories I established to perpetuate the original location of this corner.

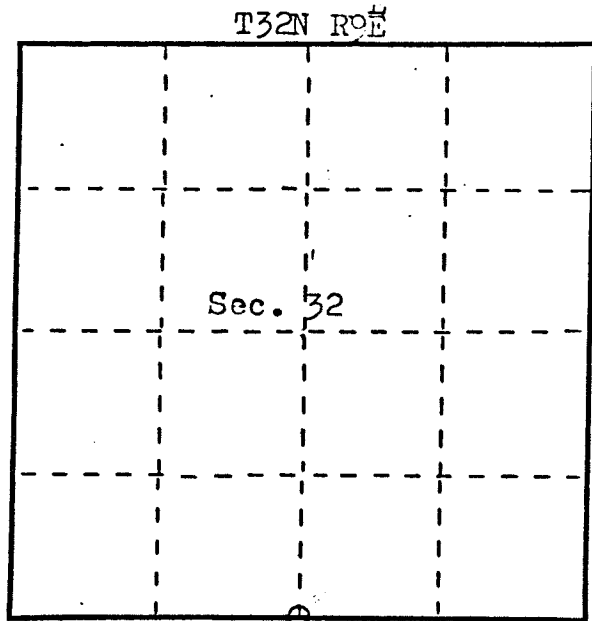
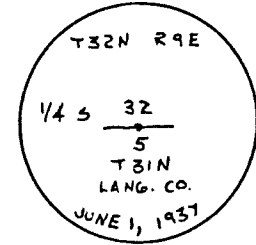
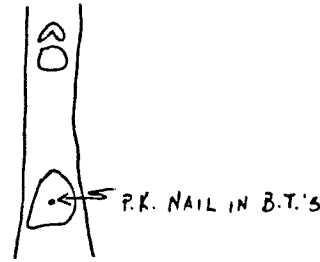
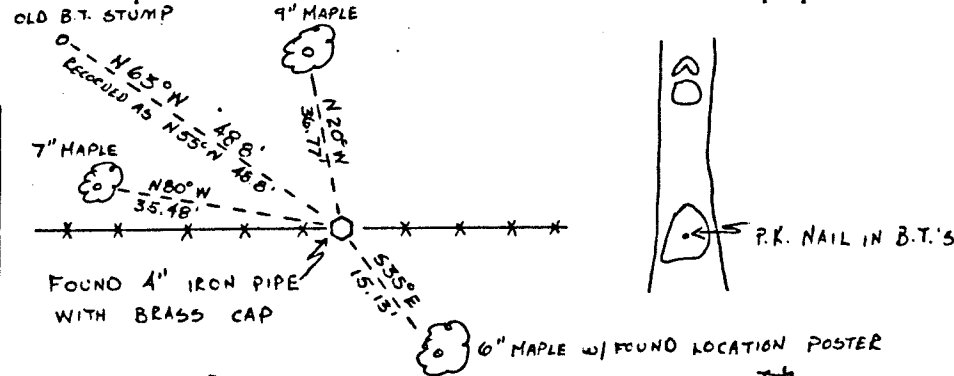

○ = Corner monument restored.

Dated at ELCHO, Wis., this 7<sup>th</sup> day of JAN, 1980.

Signature *William F. Kelly* Title County Surveyor Registration No. 1098  
(County Surveyor, Registered Land Surveyor, or other duly authorized official)

Office of Register of Deeds, County of....., I hereby certify that the within instrument was filed in this office for record on the..... day of....., 19..... at..... o'clock..... M.

(Register of Deeds)

By..... Deputy

43209320020

FORM 985 S. S. WILCOX CO., MILWAUKEE