

# U.S. PUBLIC LAND SURVEY MONUMENT RECORD

(Prepared and as required by S. A-E 7.08 WI Administrative Code)

The West 1/4 of Section 27, T.32 N., R.9 E, Langlade County, WI

43209282000

Corner was: (check all that apply)

- Restored through acceptance of an obliterated evidence location
- Restored through acceptance of a found perpetuated location.
- Determined to be lost and re-established through proportionate methods.  
(Show bearings and distance to PLSS corners used for proportioning.)
- Restored/recovered in a location that differs from a previously established position.  
(Show difference in plan view below.)
- Check here if additional information is shown on the reverse side of this form.

Describe record evidence, recovered physical evidence, occupational evidence, testimonial evidence and all other evidence considered in the recovery/restoration of the corner.

September 1860, corner was originally set by HC Fellows.

Birch 8" S35°W 27 links  
Birch 12" N22°E 23 links

April 2005, I found a good fence running east and west, no evidence of original BTs or subsequent perpetuation. I set 1/4 corner at intersection of East-West fence and extension of a town road, currently called Fielder Rd.

Physical description of the monument set:

Set 2.375 x 30 in iron pipe with a 3.25 in Langlade County brass cap.

Describe the accessories used to perpetuate the location of the corner. Include a plan view drawing and indicate accessories found/set. Describe measuring point on bearing trees. Show any topographic features that would aid in future recovery of the corner.

- LINE-1 N39°E 52.25'
  - LINE-2 S49°E 35.90'
  - LINE-3 S61°W 26.50'
  - LINE-4 N25°W 36.10'
- NW 1/4  
BT BEARINGS MAGNETIC HAND COMPASS  
BT DISTANCES TO ALUMINUM NAIL IN TREE  
BTs BLAZED WITH SIGN ATTACHED  
SECTION AND 1/4 LINE BEARINGS REFERENCED TO NORTH SECTION LINE BEARING N86°09'32"E PER HWY DEPT. ALIGNMENT DRAWING.

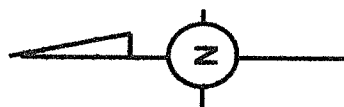
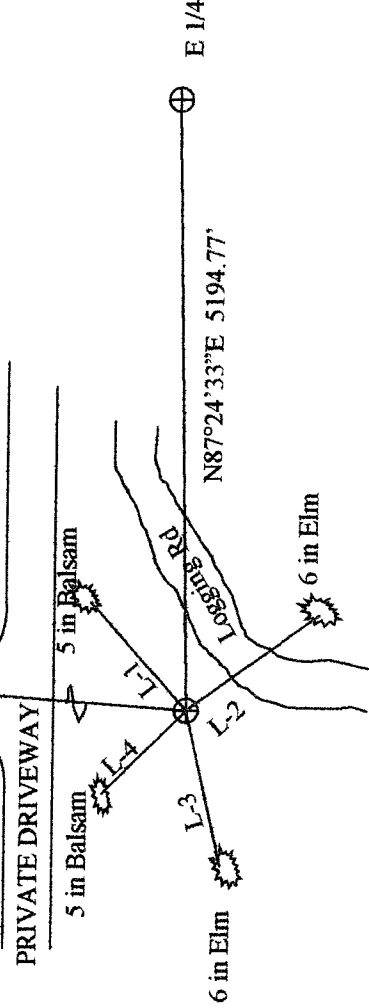

SURVEYOR'S SEAL

The West 1/4  
of Section 27  
T.32N., R.9E.  
Langlade County, WI

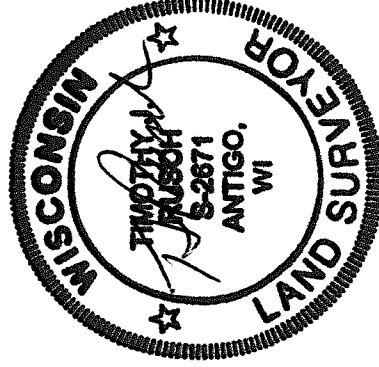

I, TIMOTHY J. RUSCH, certify that the Corner location shown on this record was determined By me or under my direction and control and that this U.S. Public Land Survey Monument Record is correct And complete to the best of my knowledge and belief.

*T. Rusch*  
Signature

6-29-2005  
Date

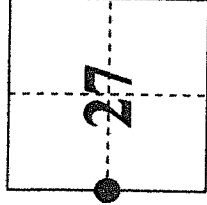

INDEX NO. T13 32-9