

CERTIFIED LAND CORNER RESTORATION

Index No. N-1

State of Wisconsin }
County of LANGLADE } ss.

I WILLIAM F. KELLY, do hereby certify that on the 3RD day of Nov., 1981, I found evidence of the SW corner of Sec. 18 Township 32, North, Range 10 EAST, Fourth Principal Meridian, as described hereon; and that from this evidence I established a new monument and accessories as described hereon to perpetuate the original location of this corner.

Resident witnesses:

.....
.....
.....

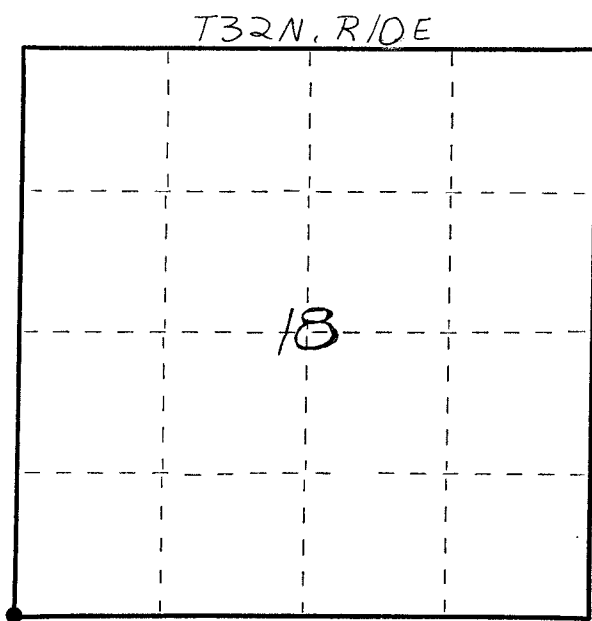

○ = Corner monument restored.

History of original corner establishment:

ORIGINAL CORNER ESTABLISHED
By HIRAM C. FELLOWS IN SEPT., 1860

Description of corner evidence found:

1 1/4" IRON PIPE, FOUND IN PLACE.
SET A 42"x2" BLACK IRON PIPE
WITH BRASS CAP WIT. MONUMENT.

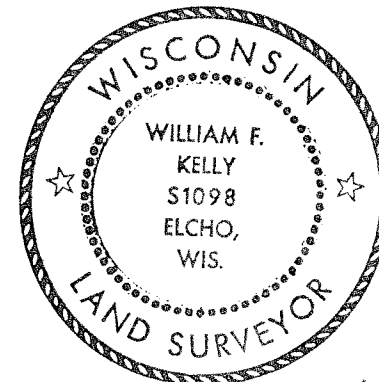

William F. Kelly

Description of monument and accessories I established to perpetuate the original location of this corner.

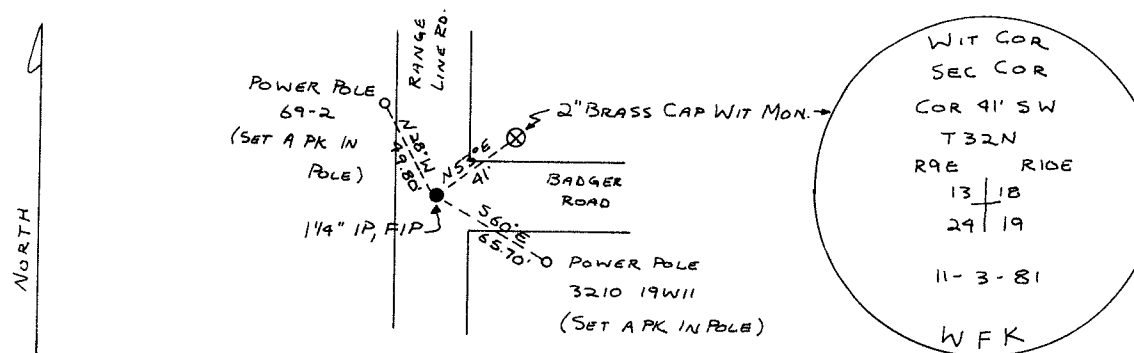

Dated at ELCHO, Wis., this 3RD day of Nov., 1981.

Signature William F. Kelly Title COUNTY SURVEYOR Registration No. 1098
(County Surveyor, Registered Land Surveyor, or other duly authorized official)

Office of Register of Deeds, County of....., I hereby certify that the within instrument was filed in this office for record on the..... day of....., 19..... at..... o'clock..... M.

.....
(Register of Deeds)

By..... Deputy