

CERTIFIED LAND CORNER RESTORATION

Index No. D-20

State of Wisconsin }
County of LANGLADE } ss.

I WILLIAM F. KELLY, do hereby certify that on the 20th day of OCTOBER, 1982, I found evidence of the SE 1/4 corner of SECTION 2 Township 32, North, Range 9 EAST, Fourth Principal Meridian, as described hereon; and that from this evidence I established a new monument and accessories as described hereon to perpetuate the original location of this corner.

Resident witnesses:

.....
.....
.....

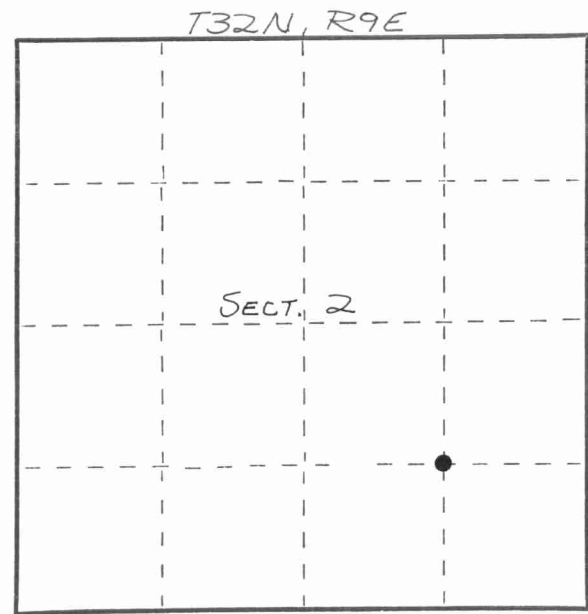

○ = Corner monument restored.

History of original corner establishment:
CORNER NOT ESTABLISHED DURING ORIGINAL GOV'T SURVEY.

Description of corner evidence found:
COR. EST. FROM G-I CONTROL SURVEY OF SECT 2 T32N R9E



William F. Kelly
12-12-82

Description of monument and accessories I established to perpetuate the original location of this corner.

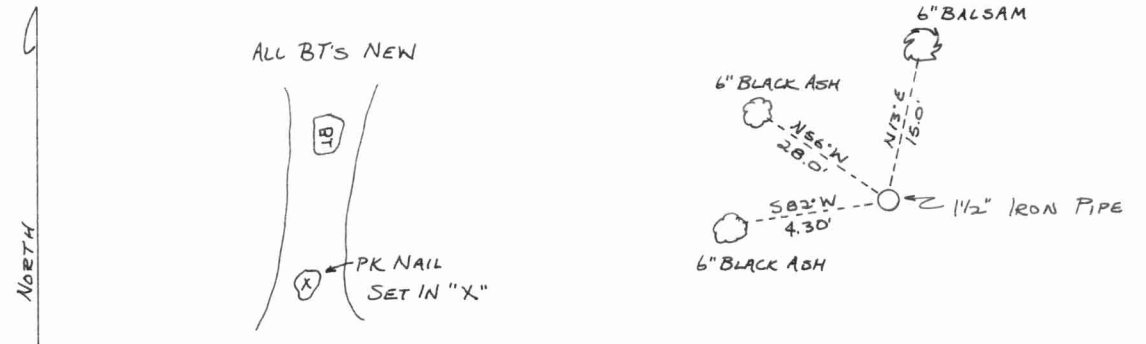

Dated at ELCHO, Wis., this 20th day of OCTOBER, 1982.

Signature William F. Kelly Title COUNTY SURVEYOR Registration No. 1098
(County Surveyor, Registered Land Surveyor, or other duly authorized official)

Office of Register of Deeds, County of _____, I hereby certify that the within instrument was filed in this office for record on the _____ day of _____, 19____ at _____ o'clock _____ M.

.....
(Register of Deeds)

By _____ Deputy

FORM 985 H. C. MILLER CO., MILWAUKEE