

U. S. PUBLIC LAND SURVEY MONUMENT RECORD

I N S T R U C T I O N S :

This record shall show the location of the corner and shall include all of the following nine elements (a through i).

- (a) Identify the corner by reference to the U.S. public land survey system.
 ○ = Corner monument restored.
 ■ = Existing corner at time of restoration.
 Set west one quarter corner of Section 28 Doty Township, Oconto County or the east one quarter corner of Section 29 Wolf River Township, Langlade County, Wisconsin, T31N, R15E, Fourth Principal Meridian.
 Bearing is from solar observation at southeast corner of Section 33.

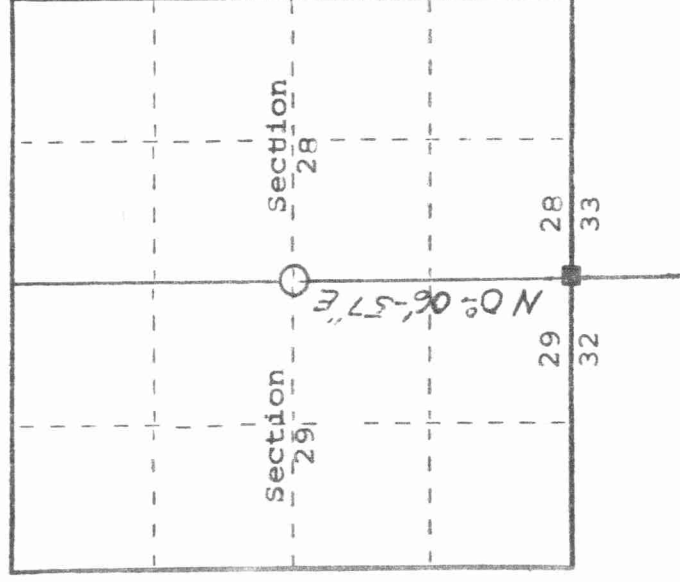

- (b) Describe any record evidence, monument evidence, occupational evidence, occupational evidence, testimonial evidence or any other material evidence you considered, and whether the monument was found or placed.
 Corner set in September 1857 by James McBride, U.S. Deputy Surveyor.

Original References:

- 8" Beech S89°W 34 links - found stump hole
 10" Beech N82°E 61 links - found evidence of a tree which had been uprooted

- (c) In the plan view drawing below, provide reference ties to at least 4 witness monuments, or, if the location is within a municipality, to at least 2 witness monuments. (Witness monuments shall be made of concrete, natural stone, iron or other equally durable material.)
 Describe witness monuments.

- (d) Show a plan view drawing depicting the relevant monuments and reference ties which is sufficient in detail to enable accurate relocation of the corner monument if the corner monument is disturbed. Indicate north.

LEGEND

- Set Standard Oconto County Monument.
 (4" X 30" cast aluminum monument)
- Set one inch reference marker.

Bearings on the sketch are magnetic.

Distances are to the face of each tree.

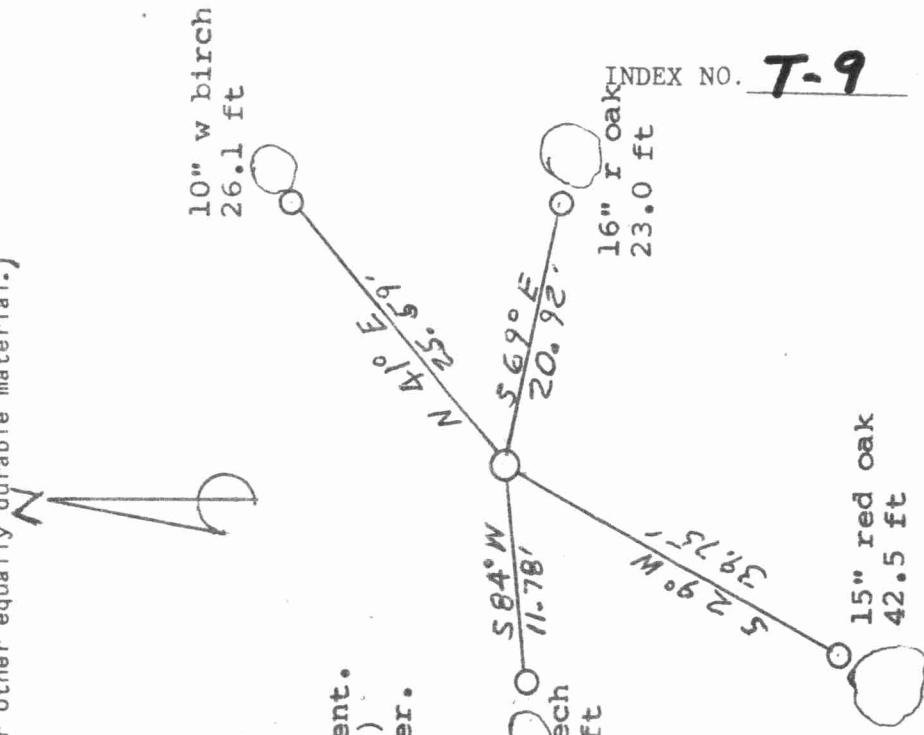

(e) Describe any material discrepancy between the location of the corner as restored or reestablished and the location of that corner as previously restored or reestablished by distance and direction. Show the discrepancy on the plan view drawing under (d), above. Show the distances between the corner as previously restored or reestablished and (1) the corner as restored or reestablished, and (2) to at least 2 of the witness monuments shown on the drawing in (d), above.

First restoration.

(f) Was the corner restored through acceptance of (1) an obliterated evidence location, or, (2) a found perpetuated location?
Through obliterated evidence olcation. Found an old post with tag beside a cruiser post. Also found a post hole in the middle of a rock pile.

(g&h) Was the corner reestablished through lost corner proportionate methods? If so, show the method, including the directions and distances to other public land survey corners used as evidence or used for proportioning in determining the corner location?

NO

(i) I, John C. Schulke (type or print name) certify that the corner location shown on this record was determined by me or under my direction and control and that this U.S. Public Land Survey Monument Record is correct and complete to the best of my knowledge and belief.

John C. Schulke
Signature

8-17-84
Date

