

Langlade Co.
Land Surveyor

U. S. PUBLIC LAND SURVEY MONUMENT RECORD

I N S T R U C T I O N S :

This record shall show the location of the corner and shall include all of the following nine elements (a through i).

- (a) Identify the corner by reference to the U.S. public land survey system.
- = Corner monument restored.

Meander corner to Sections 20 and 29, T.31N., R.15E., Langlade County.

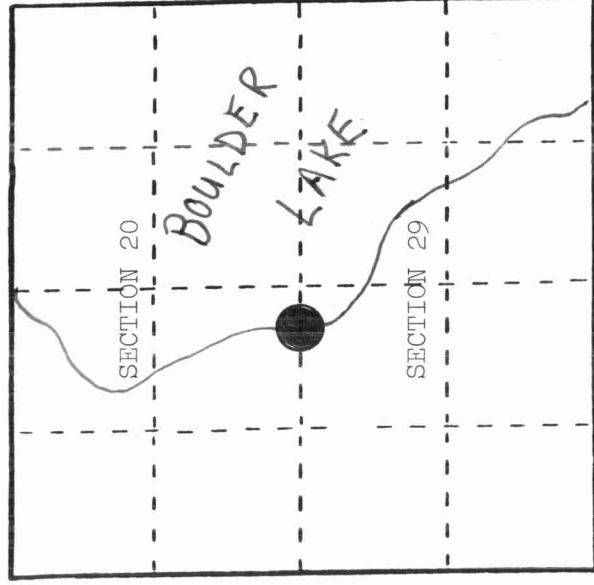

- (b) Describe any record evidence, monument evidence, occupational evidence, testimonial evidence or any other material evidence you considered, and whether the monument was found or placed.

In 1857, James McBride set meander corner post and made the following BTs: Hemlock, 6", N.78°W., 43 links; Hemlock, 6", S.7°W., 11 links.

In 1984, Milo Stefan found 2" iron pipe back from lakeshore and under old fence line which runs along section line to Sections 20 and 29. Monumented as best evidence of corner.

In 1986, Alan Harrison, upon search and reevaluation of Stefan's corner, found that iron pipe was set in 1961 by R. Pederson as lot corner on north lot of subdivision of Government Lot 1, Section 29. Due to lack of any original or perpetuated evidence of the meander corner, positioned this corner at record distance from the quarter corner west and on line with the old fence line.

- (c) In the plan view drawing below, provide reference ties to at least 4 witness monuments, or, if the location is within a municipality, to at least 2 witness monuments. (Witness monuments shall be made of concrete, natural stone, iron or other equally durable material.) Describe witness monuments.

- (d) Show a plan view drawing depicting the relevant monuments and reference ties which is sufficient in detail to enable accurate relocation of the corner monument if the corner monument is disturbed. Indicate north.

1. 2½" x 36" aluminum monument stamped to identify the corner location.
2. White Birch, 8", S.80°W., 48.26'
3. White Birch, 12", N.31°W., 33.01'
4. White Birch, 10", N.51°W., 44.60'
5. 2" iron pipe, West, 24.00'
6. Steel Sign Post, East, 1.00'

