

U.S. PUBLIC LAND SURVEY MONUMENT RECORD

(Prepared and as required by S. A-E 7.08 WI Administrative Code)

The W. 1/4 corner of Section 35, T. 31 N., R. 14 E., Langlade County, WI

Corner was: (check all that apply)

- Restored through acceptance of an obliterated evidence location.
- Restored through acceptance of a found perpetuated location.
- Determined to be lost and re-established through proportionate methods.
(Show bearings and distances to PLSS corners used for proportioning.)
- Restored/recovered/reestablished in a location that differs from a previously established position. (Show difference in plan view below.)
- Check here if additional information is shown on the reverse side of this form.

Describe record evidence, recovered physical evidence, occupational evidence, testimonial evidence and all other evidence considered in the recovery/restoration of the corner.

1857--SUBDN OF TWP. BY JAMES MCBRIDE, N. BETWEEN SEC'S. 34 & 35--40.0 CHS. SET 1/4 POST, B.Ts--SUG. 10" S.80 W. 26 LKS., SUG. 10" N.1 E. 48 LKS.
 1980--KELLY R.L.S.#S-1098, SET P.K. NAIL AT COR.
 1986--SEYMOUR R.L.S.#S-1412 SET P.K. NAIL IN NEW BLACKTOP SURFACE FROM DATA FROM KELLY C.S.M. #253568, FILLED MONUMENT RECORD SHEET, AT LATER DATE CHANGED IDENT. OF CORNER FROM P.K. TO IRON ROD.
 1999--DOBBRATZ, R.L.S.#S-973 FOUND 5/8" DIA. IRON ROD AT SEYMOUR 1/4 CORNER LOCATION, TIED OFF CORNER PRIOR TO NEW PAVING OF C.T.H."M".

Physical description of the monument set:

DROVE A 4 1/2" LONG, GEAR HEADED SPIKE SUPPLIED BY COUNTY SURVEYOR AT FORMER LOCATION OF 1/4 CORNER

Describe the accessories used to perpetuate the location of the corner. Include a plan view drawing and indicate accessories found/set. Describe measuring point on bearing trees. Show any topographic features that would aid in future recovery of the corner.

EXISTING & NEW ACCESSORIES

- ① - FOUND A 1 1/2" DIA. IRON PIPE N.53° -39'E. 46.64FT.
(PREV. N.45° E. 46.67FT.)
- ② - DROVE A 3/4" DIA. IRON ROD S.34° E. 49.14 FT.
- ③ - " " " S.50° -25'W. 47.86 FT.
- ④ - " " " N.45° -44'W. 65.69 FT.
- ⑤ - 1/4 SECTION CORNER DROVE A 4 1/2" LONG GEAR HEADED SPIKE

SET A PLASTIC POST WITH SURVEY MARKER STICKER 0.5 FT. SE OF ACCESSORY NO. 2, BEARINGS ARE MAGNETIC IRON RODS SET HAVE LANGLADE CO, PLASTIC CAPS

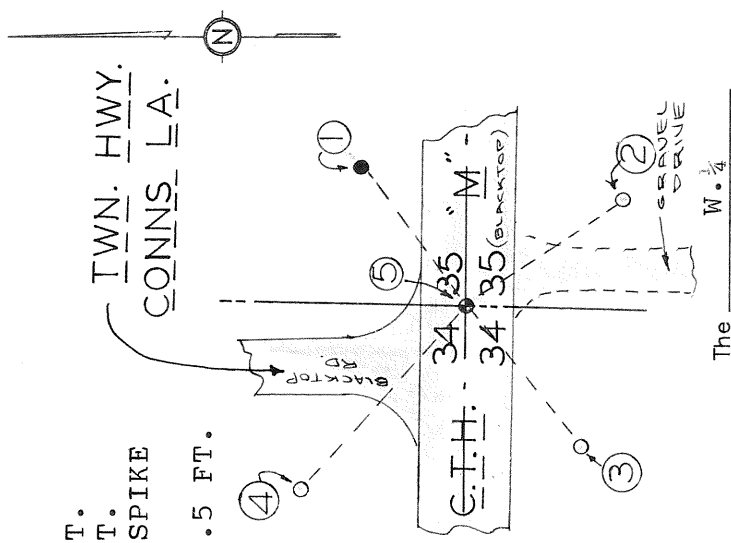

The _____ corner of Section 35
 SURVEYORS SEAL

T. 31 N., R. 14 E.
 Langlade County, WI

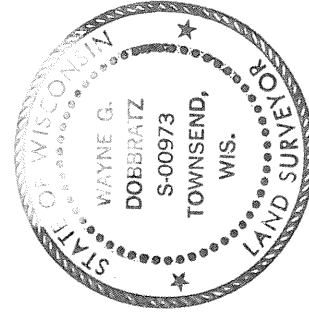

I, W.G. DOBBRATZ, certify that the corner location shown on this record was determined by me or under my direction and control and that this U.S. Public Land Survey Monument Record is correct and complete to the best of my knowledge and belief.

Wayne G. Dobbratz 10/25/99
 Signature Date

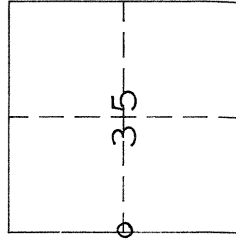

○ = Location of corner

INDEX No. X-17