

U.S. PUBLIC LAND SURVEY MONUMENT RECORD

(Prepared and as required by S. A-E 7.08 WI Administrative Code)

The N. ½ corner of Section 36, T. 31 N., R. 14 E., Langlade County, WI

Corner was: (check all that apply)

- Restored through acceptance of an obliterated evidence location.
 Restored through acceptance of a found perpetuated location.

- Determined to be lost and re-established through proportionate methods.
(Show bearings and distances to PLSS corners used for proportioning.)
 Restored/recovered/reestablished in a location that differs from a previously established position. (Show difference in plan view below.)

- Check here if additional information is shown on the reverse side of this form.

Describe record evidence, recovered physical evidence, occupational evidence, testimonial evidence and all other evidence considered in the recovery/restoration of the corner.

1857--SUBDN. OF TWP. BY JAMES McBRIDE, W. COR. BETWEEN SEC'S. 25 & 36, 40.0CHS. SET ¼ POST, B.TS. BIR. 10" S.17°E. 29 LKS., BIR. 10" N.43°E. 37 LKS.

1985--ARNOTT R.L.S. # S-887 SET ALUM. MONUMENT, NO RESTORATION SHEET FILED
1987--SEYMOUR R.L.S.# S-1412, SURVEYED SEC. 25, FOUND ARNOTT MONUMENT TO BE OUT OF PLACE, N.0°-53'-45"E. 14.20FT. FROM TRUE LOCATION

1987--KELLY R.L.S.# S-1098, SET 2" DIA. IRON PIPE WITH BRASS CAP STAMPED TO IDENTIFY COR. AT SEYMOUR LOCATION--B.Ts--10" MAP. N.69°W. 24.08FT., 15" MAP. N.12°E. 35.64FT., 13" MAP. N.38°W. 9.93FT., 12" MAP. N.25°E. 18.09FT.

1999--DOBBRATZ R.L.S # 973, FOUND MONUMENT PLACED BY KELLY, B.Ts--13" MAP. IS DEAD, 12" MAP. HAS BEEN CUT DOWN.

Physical description of the monument set:

FOUND 2" DIA. IRON PIPE WITH BRASS CAP STAMPED TO IDENTIFY CORNER

Describe the accessories used to perpetuate the location of the corner. Include a plan view drawing and indicate accessories found/set. Describe measuring point on bearing trees. Show any topographic features that would aid in future recovery of the corner.

EXISTING & NEW ACCESSORIES

- ① B.T. 22" MAP. N.20°E. 36.36FT. (EXISTING, PLACED NEW NAIL)
- ② B.T. 10" MAP. S.16°E. 34.38FT. (NEW)
- ③ B.T. 7" MAP. S.48°W. 9.76FT. (NEW)
- ④ B.T. 19" MAP. N.69°W. 24.08FT.(EXISTING, USED EXISTING NAIL IN E'LY FACE OF TREE)
STAMPED TO IDENTIFY COR.
- ⑤ N. ½ COR. FOUND 2" DIA. IRON PIPE WITH BRASS CAP STAMPED TO IDENTIFY COR.

SET PLASTIC POST WITH SURVEY MARKER STICKER 2FT. WEST OF COR., BEARINGS ARE MAGNETIC & ARE TAKEN TO THE CENTER OF B.Ts, DIMENSIONS ARE TO A NAIL IN SIDE OF B.T. EXCEPT B.T. 4 OF WHICH A FOUND NAIL WAS USED IN THE E'LY FACE OF TREE, PREVIOUS & NEW B.Ts WERE BLAZED & PAINTED BLUE, ALUMINUM B.T TAGS WERE PLACED ON ALL B.Ts.

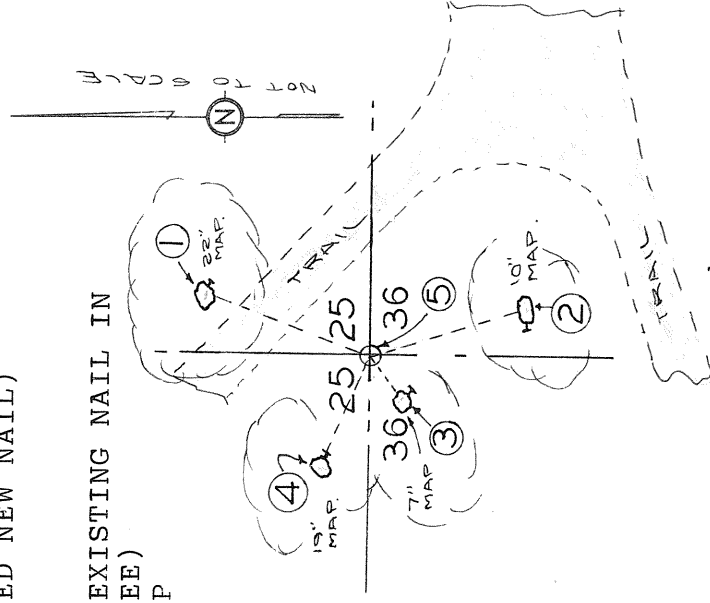

The N. ½

SURVEYORS SEAL

corner of Section 36

T. 31 N., R. 14 E.
Langlade County, WI

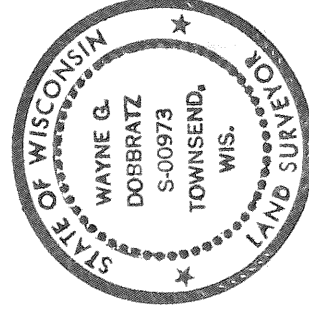

INDEX No. V-23

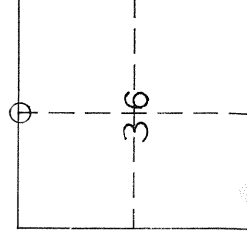

○ = Location of corner

I, W.G. DOBBRATZ, certify that the corner location shown on this record was determined by me or under my direction and control and that this U.S. Public Land Survey Monument Record is correct and complete to the best of my knowledge and belief.

Wayne G. Dobbratz 4/18/99
Signature Date