

CERTIFIED LAND CORNER RESTORATION

Index No. R-24

State of Wisconsin }  
 County of LANGLADE } ss.

I WILLIAM F. KELLY, do hereby certify that on the 15<sup>th</sup> day of MARCH, 1981, I found evidence of the E 1/4 corner ON S. LINE, SEC. 24 Township 31, North, Range 14 EAST, Fourth Principal Meridian, as described hereon; and that from this evidence I established a new monument and accessories as described hereon to perpetuate the original location of this corner.

Resident witnesses:  
 \_\_\_\_\_  
 \_\_\_\_\_  
 \_\_\_\_\_

History of original corner establishment:

ORIGINAL CORNER ESTABLISHED  
BY JAMES L. NOWLIN, APRIL, 1865

Description of corner evidence found:

EST. CORNER AT MIDPOINT BETWEEN  
S 1/4 COR AND SE SECT CORNER  
SECT 24 T31N R14E

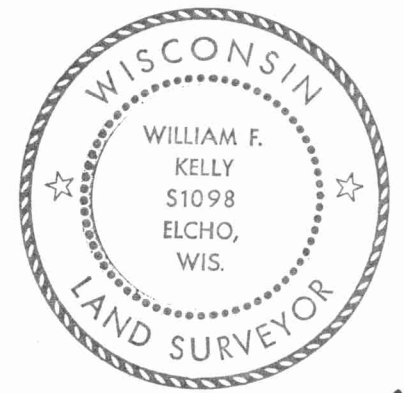

*William F. Kelly*

SET A 1 1/2" GALVANIZED PIPE AND CAP IN ROCKPILE

Description of monument and accessories I established to perpetuate the original location of this corner.

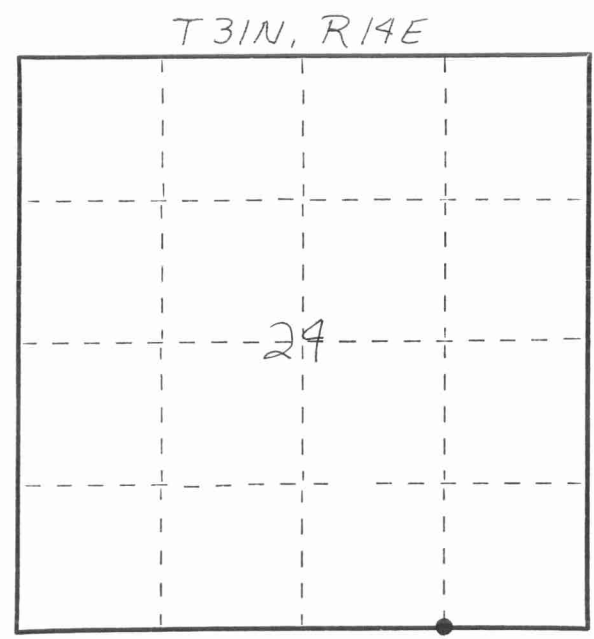
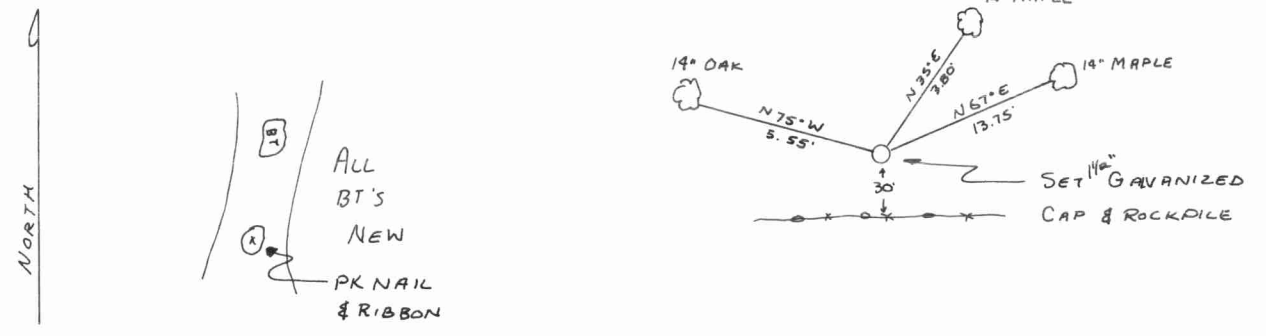

○ = Corner monument restored.

Dated at ELCHO, Wis., this 15<sup>th</sup> day of MARCH, 1981.

Signature William F. Kelly Title COUNTY SURVEYOR Registration No. 1098  
 (County Surveyor, Registered Land Surveyor, or other duly authorized official)

Office of Register of Deeds, County of \_\_\_\_\_, I hereby certify that the within instrument was filed in this office for record on the \_\_\_\_\_ day of \_\_\_\_\_, 19\_\_\_\_ at \_\_\_\_\_ o'clock \_\_\_\_\_ M.

(Register of Deeds)

By \_\_\_\_\_ Deputy

FORM 985 H. C. MILLER CO., MILWAUKEE

