

CERTIFIED LAND CORNER RESTORATION

Index No. P-21

State of Wisconsin }
 County of LANGLADE } ss.

History of original corner establishment:

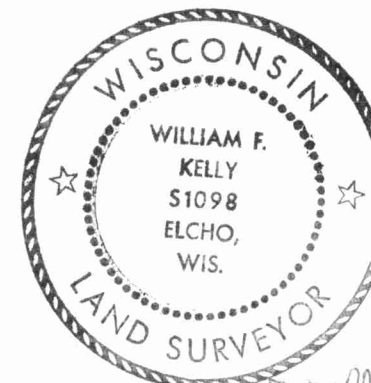

I WILLIAM F. KELLY, do hereby certify that on the 18th day of NOVEMBER, 1974, I found evidence of the 1/4 corner of SECTION 23 & 24 Township 31^{14E}, North, Range 14E, Fourth Principal Meridian, as described hereon; and that from this evidence I established a new monument and accessories as described hereon to perpetuate the original location of this corner.

Description of corner evidence found:

I LOCATED A SQUARED POST WITH POINTED TOP BETWEEN TWO MARKED TREES AT THE INTERSECTION OF BLAZED LINES.

William F. Kelly



Resident witnesses:

.....

Description of monument and accessories I established to perpetuate the original location of this corner.

I SET A 2" BLACK IRON PIPE WITH A MARKED BRASS CAP FOR CORNER AND RESET THE WOOD POST AS A WITNESS POST.

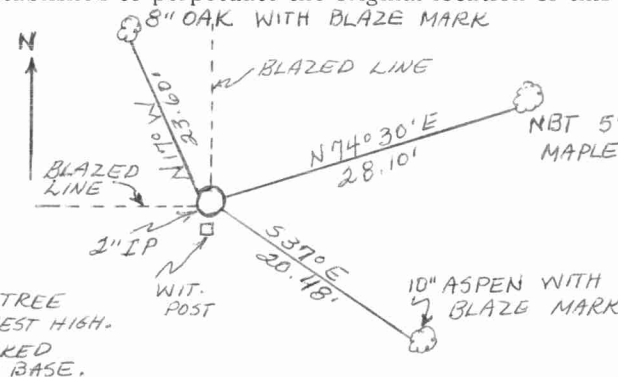

NEW BEARING TREE
 BLAZED NBT CHEST HIGH.
 ALL TREES MARKED
 WITH A + AT BASE.



FORM 985 R. C. MILLER CO., MILWAUKEE

T. 31N. - R. 14E.

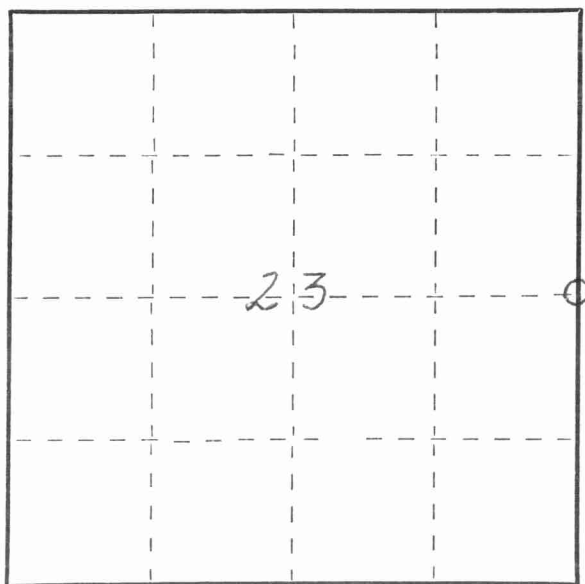

○ = Corner monument restored.

Dated at ELCHO, Wis., this 18th day of NOVEMBER, 1974.

Signature William F. Kelly Title REGISTERED LAND SURVEYOR Registration No. S. 1098
 (County Surveyor, Registered Land Surveyor, or other duly authorized official)

Office of Register of Deeds, County of _____, I hereby certify that the within instrument was filed in this office for record on the _____ day of _____, 19____ at _____ o'clock _____ M.

.....
 (Register of Deeds)

By _____ Deputy

