

CERTIFIED LAND CORNER RESTORATION

Index No. K-23

State of Wisconsin }
 County of LANGLADE } ss.

History of original corner establishment:

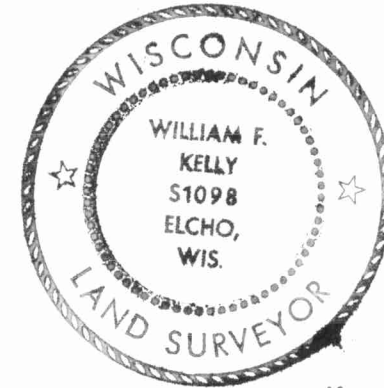

William F. Kelly

I WILLIAM F. KELLY, do hereby certify that on the 4th day of DECEMBER, 1974, I found evidence of the NORTH 1/8 corner of SECTION 13 Township 31, North, Range 14 EAST, Fourth Principal Meridian, as described hereon; and that from this evidence I established a new monument and accessories as described hereon to perpetuate the original location of this corner.

Description of corner evidence found:

ESTABLISHED THE NORTH 1/8 CORNER ON THE N - S 1/4 LINE, SECTION 13, T.31N.-R.14E. AS PART OF CONTROL SURVEY FOR SUBDIVISION.

Resident witnesses:

.....

Description of monument and accessories I established to perpetuate the original location of this corner.

SET 1 1/2" BLACK IRON PIPE WITH BRASS CAP MARKED:

NOTE: THE N 1/4 COR AND THE CENTER SECTION 13 FALL ON THE FENCE LINE. FENCE LINE CURVES PAST THE 40 CORNER. NEW BEARING TREES BLAZED NBT CHEST HIGH AND MARKED WITH A + AT BASE.

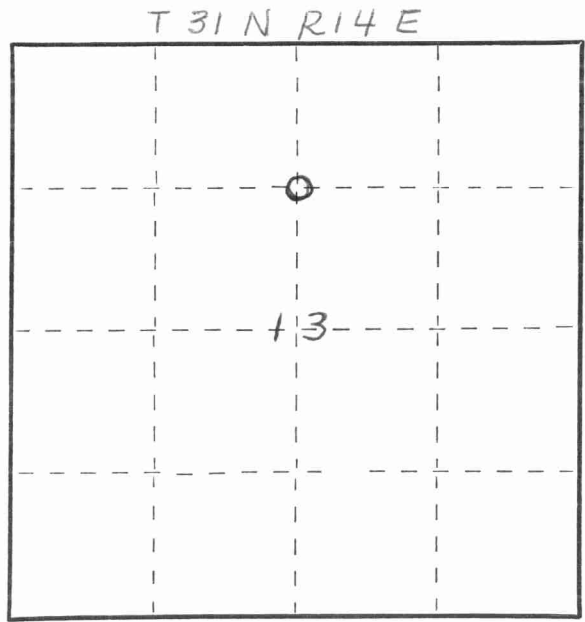
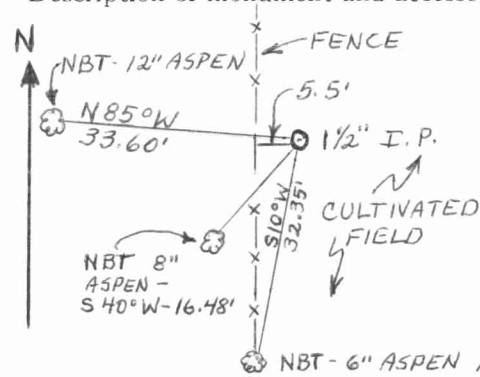

○ = Corner monument restored.

Dated at ELCHO, Wis., this 4th day of DECEMBER, 1974

Signature William F. Kelly Title REGISTERED LAND SURVEYOR Registration No. S 1098
 (County Surveyor, Registered Land Surveyor, or other duly authorized official)

Office of Register of Deeds, County of _____, I hereby certify that the within instrument was filed in this office for record on the _____ day of _____, 19____ at _____ o'clock _____ M.

(Register of Deeds)

By _____ Deputy

FORM 985 H. C. MILLER CO., MILWAUKEE

