

CERTIFIED LAND CORNER RESTORATION

Index No. L-001

State of Wisconsin }
 County of LANGLADE } ss.

I WILLIAM F. KELLY, do hereby certify that on the 3rd day of DECEMBER, 1974, I found evidence of the 1/4 SECTION corner of SECTION 13 & 18 Township 31, North, Range 14 EAST, Fourth Principal Meridian, as described hereon; and that from this evidence I established a new monument and accessories as described hereon to perpetuate the original location of this corner.

Resident witnesses:

FORM 985 H. C. MILLER CO., MILWAUKEE

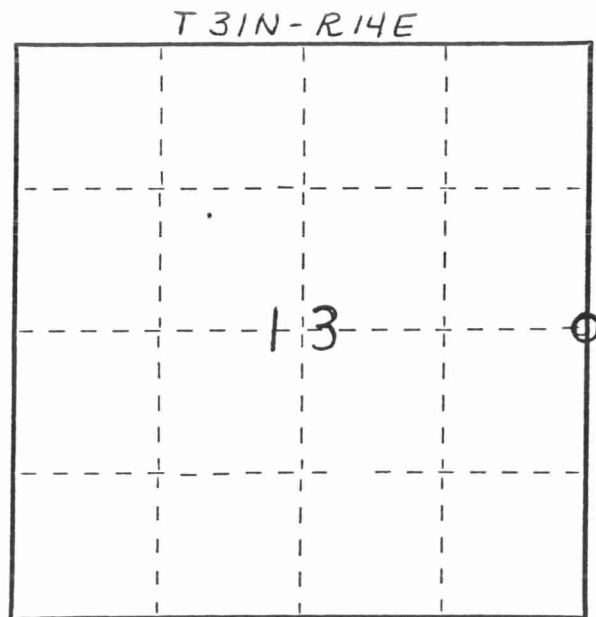

○ = Corner monument restored.

History of original corner establishment:

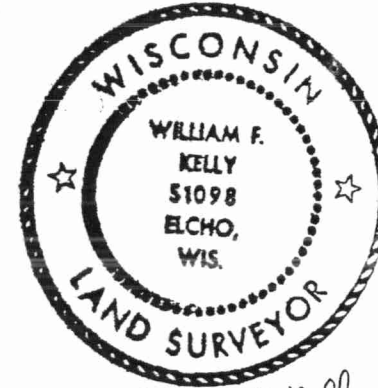

William F. Kelly

Description of corner evidence found:

ESTABLISHED THE 1/4 SECTION CORNER, SECTION 13 & 18, T.31N.-R.14E. AS PART OF CONTROL SURVEY FOR SUBDIVISION.

Description of monument and accessories I established to perpetuate the original location of this corner.

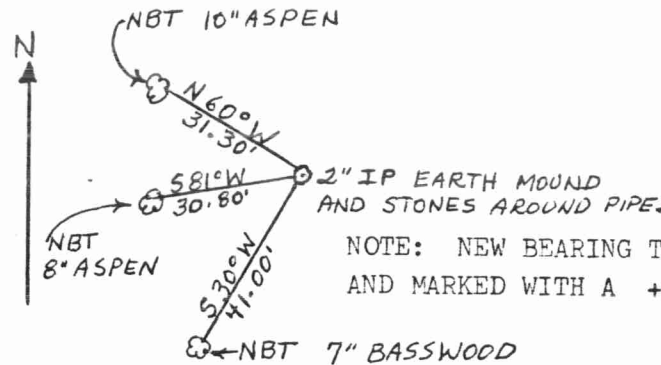

SET 2" BLACK IRON PIPE WITH BRASS CAP MARKED:

NOTE: NEW BEARING TREES BLAZED NBT CHEST HIGH AND MARKED WITH A + AT BASE.



Dated at ELCHO, Wis., this 3rd day of DECEMBER, 1974

Signature William F. Kelly Title REGISTERED LAND SURVEYOR Registration No. S.1098
 (County Surveyor, Registered Land Surveyor, or other duly authorized official)

Office of Register of Deeds, County of _____, I hereby certify that the within instrument was filed in this office for record on the _____ day of _____, 19____ at _____ o'clock _____ M.

 (Register of Deeds)

By _____ Deputy