

CERTIFIED LAND CORNER RESTORATION

Index No. M-1

31-15

State of Wisconsin }
County of LANGLADE } ss.

I WILLIAM F. KELLY, do hereby certify that on the 2nd day of DECEMBER, 1974, I found evidence of the SOUTH 1/8 corner of SECTION 13 & 18 Township 31, North, Range 14 EAST, Fourth Principal Meridian, as described hereon; and that from this evidence I established a new monument and accessories as described hereon to perpetuate the original location of this corner.

Resident witnesses:

.....
.....
.....

SECT. 13, T.31N.-R.14E.

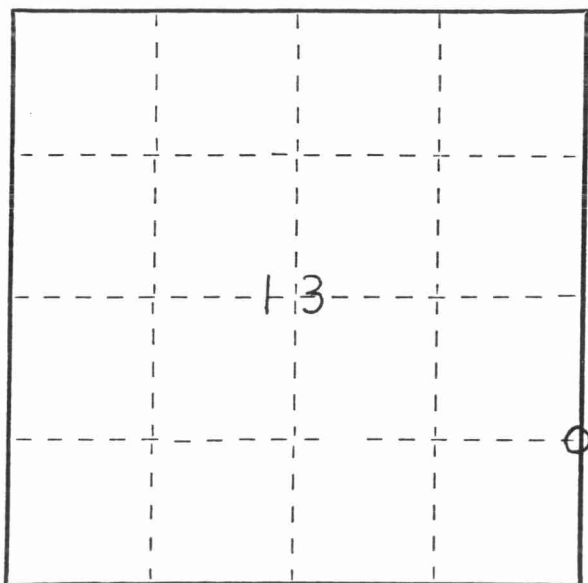

○ = Corner monument restored.

History of original corner establishment:

Description of corner evidence found:

CORNER ESTABLISHED FROM SURVEY FOR SUBDIVISION IN SECTION 13, T.31N.-R.14E.

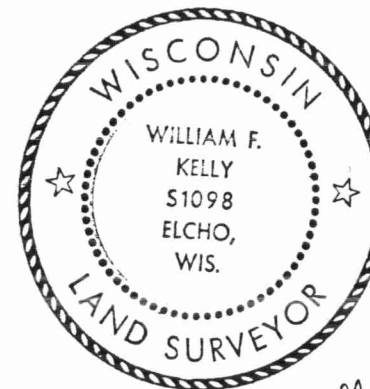

William F. Kelly

Description of monument and accessories I established to perpetuate the original location of this corner.

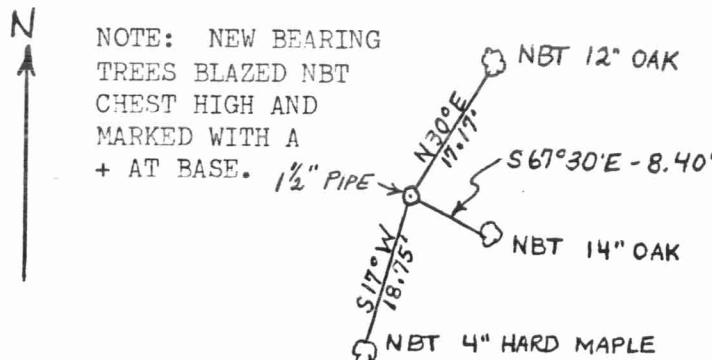

SET S 1/8 CORNER, SECTION 13 & 18 -- 1/2" BLACK IRON PIPE WITH BRASS CAP MARKED:



Dated at ELCHO, Wis., this 2nd day of DECEMBER, 1974.

Signature William F. Kelly Title REGISTERED LAND SURVEYOR Registration No. S. 1098
(County Surveyor, Registered Land Surveyor, or other duly authorized official)

Office of Register of Deeds, County of....., I hereby certify that the within instrument was filed in this office for record on the.....day of....., 19..... at.....o'clock..... M.

.....
(Register of Deeds)

By.....Deputy