

CERTIFIED LAND CORNER RESTORATION

Index No. J-24

State of Wisconsin }
County of LANGLADE } ss.

History of original corner establishment:

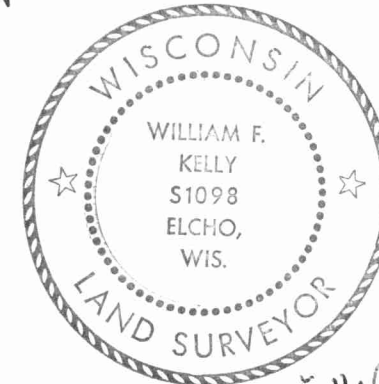

William F. Kelly

I WILLIAM F. KELLY, do hereby certify that on the 4th day of DECEMBER, 19 74, I found evidence of the EAST 1/8 corner of SECTION 12 & 13 Township 31, North, Range 14 EAST, Fourth Principal Meridian, as described hereon; and that from this evidence I established a new monument and accessories as described hereon to perpetuate the original location of this corner.

Description of corner evidence found:

ESTABLISHED THE EAST 1/8 CORNER BETWEEN SECTION 12 & 13, T.31N.R.14E. AS PART OF CONTROL SURVEY FOR SUBDIVISION.

Resident witnesses:

.....
.....
.....

Description of monument and accessories I established to perpetuate the original location of this corner.

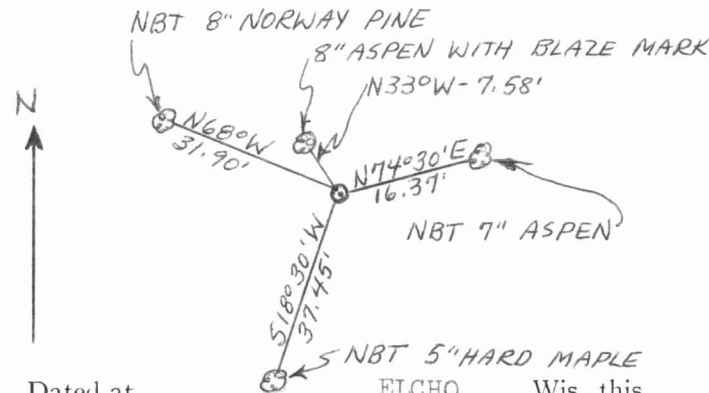

SET 1 1/2" BLACK IRON PIPE WITH BRASS CAP MARKED:

NOTE: NEW BEARING TREES BLAZED WITH NBT CHEST HIGH AND MARKED WITH A + AT BASE.

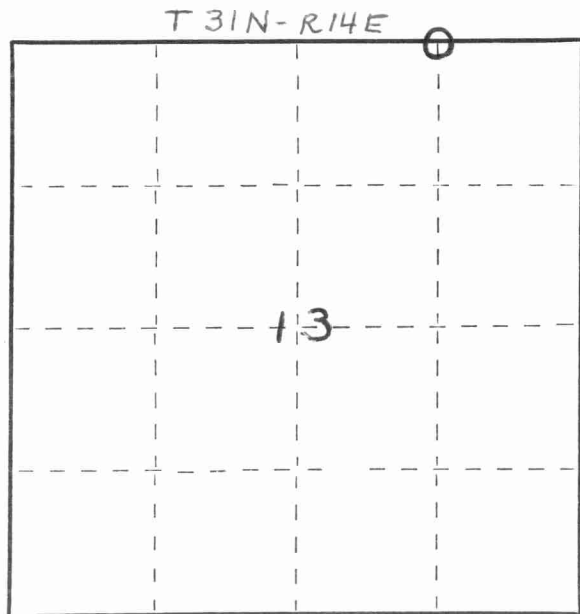

○ = Corner monument restored.

Dated at ELCHO, Wis., this 4th day of DECEMBER, 19 74.

Signature William F. Kelly Title REGISTERED LAND SURVEYOR Registration No. S 1098
(County Surveyor, Registered Land Surveyor, or other duly authorized official)

Office of Register of Deeds, County of _____, I hereby certify that the within instrument was filed in this office for record on the _____ day of _____, 19 _____ at _____ o'clock _____ M.

.....
(Register of Deeds)
By _____ Deputy

FORM 985 H. C. MILLER CO., MILWAUKEE

