

CERTIFIED LAND CORNER RESTORATION

31-14

Index No. J-17

State of Wisconsin }
County of LANGLADE } ss.

I, ROBERT J. POSS, do hereby certify that on the 24TH day of MAY, 1968, I found evidence of the corner of SEC. 10, 11, 14, 15 Township 31 North, Range 14 EAST, Fourth, Principal Meridian, as described hereon; and that from this evidence I established a new monument and accessories as described hereon to perpetuate the original location of this corner.

History of original corner establishment:

Description of corner evidence found:

IRON BOLT SET BY WEBLEY IN 1921.

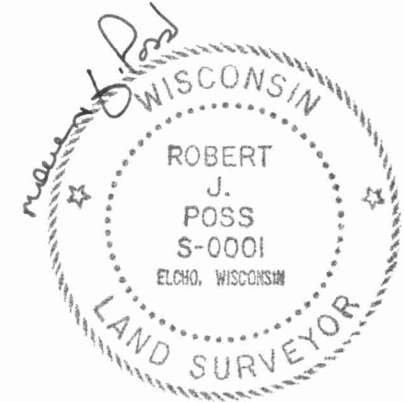

Resident witnesses:

ED. ANTONIEWICZ

Description of monument and accessories I established to perpetuate the original location of this corner.

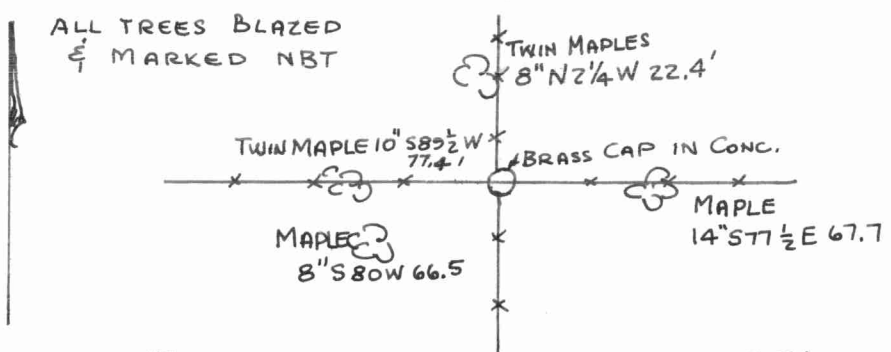
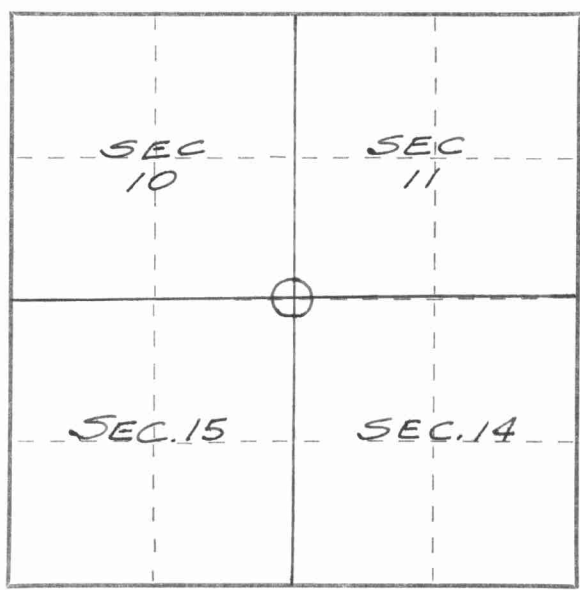

SET BRASS CAP AT BOLT
CAP MKD.
SEC. COR
SEC. 10, SEC. 11
SEC. 15, SEC. 14
CONC. MON.

Dated at ELCHO, Wis., this 27TH day of MAY, 1968.

Signature Robert J. Poss Title REG. LAND SURVEYOR Registration No. S-1
(County Surveyor, Registered Land Surveyor, or other duly authorized official)

Office of Register of Deeds, County of _____, I hereby certify that the within instrument was filed in this office for record on the _____ day of _____, 19____ at _____ o'clock _____ M.

(Register of Deeds)

By _____ Deputy

○ = Corner monument restored.

FORM 985 H. C. MILLER CO., MILWAUKEE

