

# U.S. PUBLIC LAND SURVEY MONUMENT RECORD

Note: This form is intended and designed to fulfill all requirements of Wisconsin Administrative Code, Chapter A-E 5.02, U.S. Public Land Survey Monument Record (3) (a) (b) (c) (d) (e) (f) (g) (h) (i). An additional sheet may be added if necessary to conform with said requirements.

(a) Corner location: Township 31 North

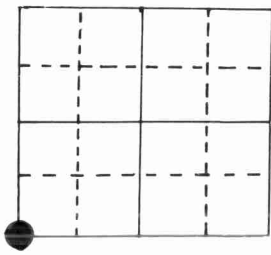

Range 14 East ~~West~~

Town/~~City/Village~~ Wolf River

County Langlade

Bernsten Aluminum Monument (buried 6" on east side gravel)

Section 15

(b) (f) (g) (h) Description of monument found at this corner and if it was accepted, state all evidence (material, testimonial, occupational, plats, records, other monuments) used as a basis for accepting. If not accepted or if nothing was found, state evidence used as basis for establishing location. If reestablished through lost corner proportionate methods, indicate all monuments, distances and directions used to establish.

Original by J. McBride, 1857, OBT's BW 10" N66°E 8 lks., Lind 14" S26°E 29 lks.,  
BW 12" S22°W 24 lks., Heml 18" N8°W 23 lks.

Robert Poss, 5/18/68, set drag tooth to replace orig. cor. vouched for by Mr. Aug. Buettner, owner of adjacent property since 1914--and former town pathmaster.

Witness cor. (brass plate in conc.) set at N 72½°E 28.0' from sec. cor.  
BT' for witness mon. are FB 8" N44¼°E 3.0', FB 8" S25¾°W 3.0'  
The other references are gone.

Seymour, 1986, found witness cor. and drag tooth for sec. cor. Replaced drag tooth with monument for sec. cor.

(c) (d) (e) Plan view of corner with ties to at least 4 witness monuments. If in disagreement with previously established corner, show the distances between the two corners and also indicate the ties to the disputed corner.

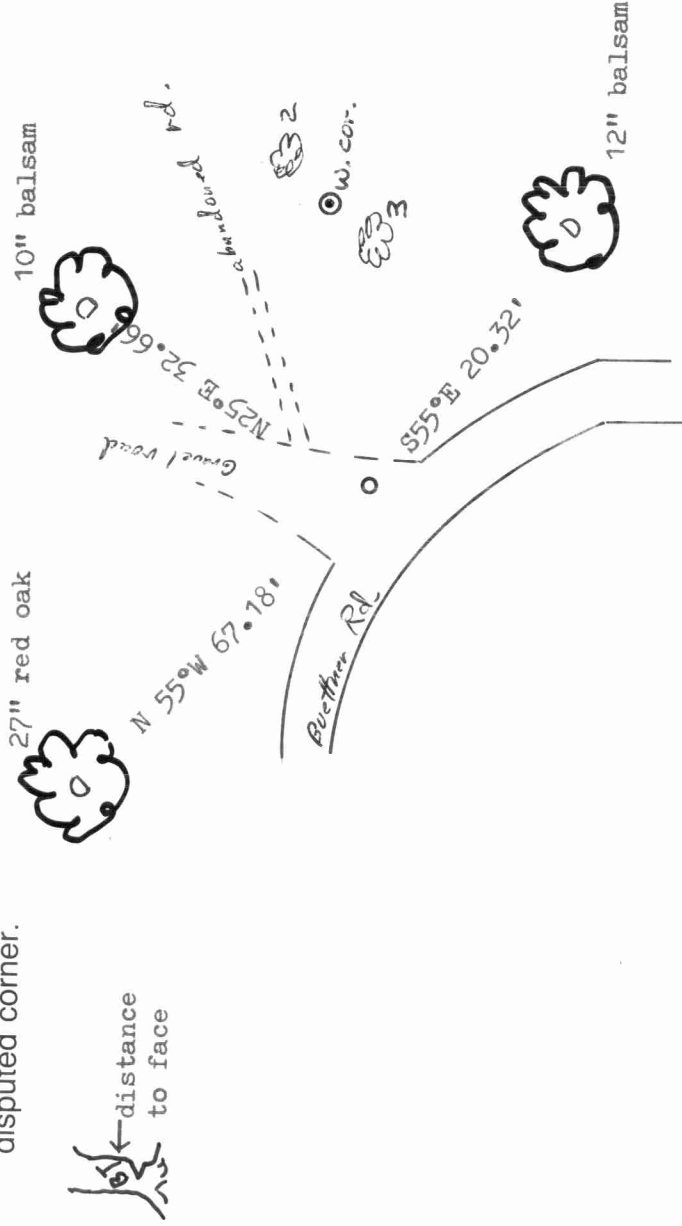

(i) I, Marvin E. Seymour

(type or print name) certify that the corner location on this record was determined by me or under my direction and control and that this U.S. Public Land Survey Monument Record is correct and complete to the best of my knowledge and belief.

Marvin E. Seymour June 19, 1986

Signature

William J. Kelly cc. Surveyor. Verified 6/25/86

Date



