

CERTIFIED LAND CORNER RESTORATION

Index No. E-1

31-15

State of Wisconsin }  
County of LANGLADE } ss.

I WILLIAM F. KELLY, do hereby certify that on the 11<sup>th</sup> day of MARCH, 1983, I found evidence of the NE corner of SECTION 12 Township B1, North, Range 14 EAST, Fourth Principal Meridian, as described hereon; and that from this evidence I established a new monument and accessories as described hereon to perpetuate the original location of this corner.

Resident witnesses:

.....  
.....  
.....

Description of corner evidence found:

REPLACED OLD BED RAIL OF UNKNOWN ORIGIN WHICH AGREES WELL WITH CALLS TO S. BRANCH OF ONTO RIVER WITH A 2" x 36" ALUM. MONUMENT. Bed Rail Recovered By John Fisher in Oct. 1982  
RES. SURVEY PLAT FOR U.S. GOVT OF SECT 12 T31N R14E

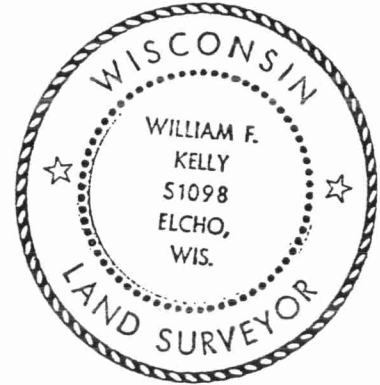

*William F. Kelly*

Description of monument and accessories I established to perpetuate the original location of this corner.

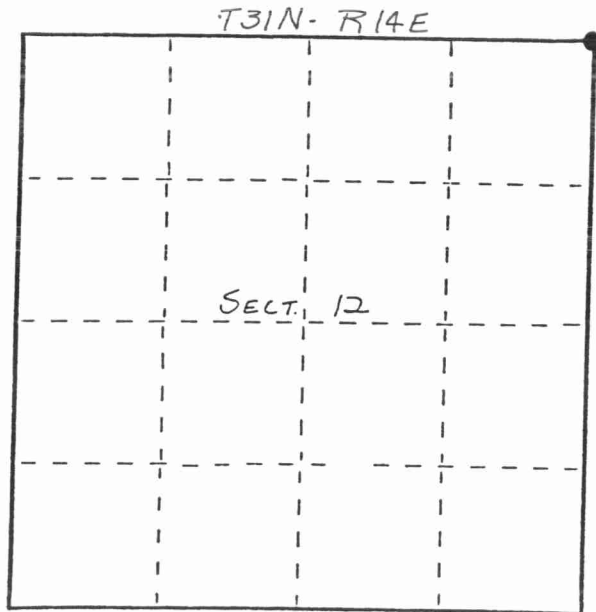
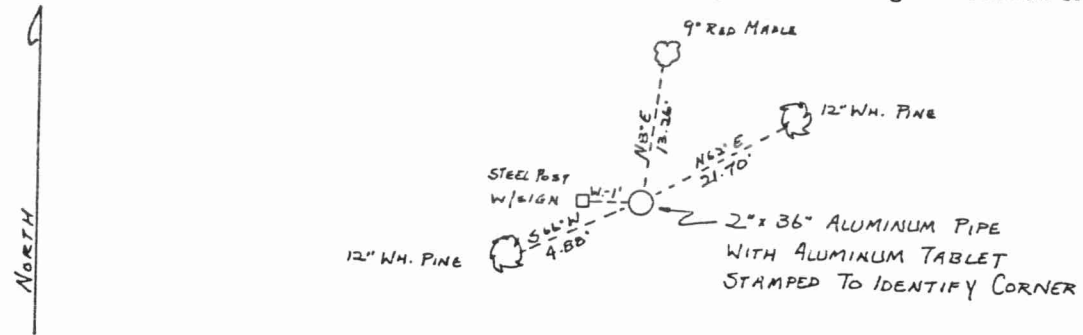

○ = Corner monument restored.

Dated at ELCHO, Wis., this 11<sup>th</sup> day of MARCH, 1983...

Signature William F. Kelly Title COUNTY SURVEYOR Registration No. 1098  
(County Surveyor, Registered Land Surveyor, or other duly authorized official)

Office of Register of Deeds, County of....., I hereby certify that the within instrument was filed in this office for record on the.....day of....., 19..... at.....o'clock..... M.

.....  
(Register of Deeds)

By.....Deputy