

CERTIFIED LAND CORNER RESTORATION

Index No. P-23

State of Wisconsin }
County of Lan glade } ss.

I Gary A. Radtke, do hereby certify that on the Twentieth day of September, 19 78, I found evidence of the Center one-quarter corner of Section 24 Township 31, North, Range 13, Fourth Principal Meridian, as described hereon; and that from this evidence I established a new monument and accessories as described hereon to perpetuate the original location of this corner.

Resident witnesses:

.....
.....
.....

T. 31N. - R. 13E. Sec. 24

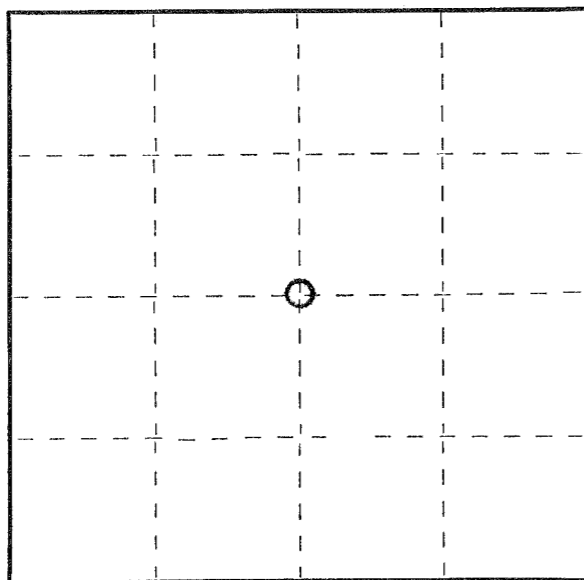

○ = Corner monument restored.

History of original corner establishment:

Old Notes

Description of corner evidence found:

Old bearing tree and fence lines

Description of monument and accessories I established to perpetuate the original location of this corner.

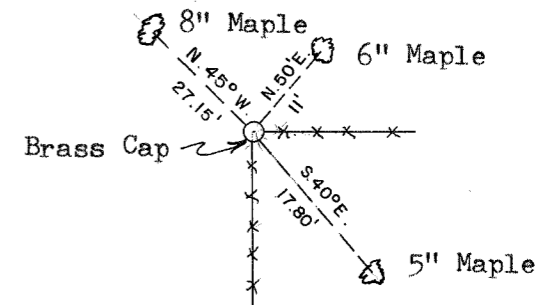
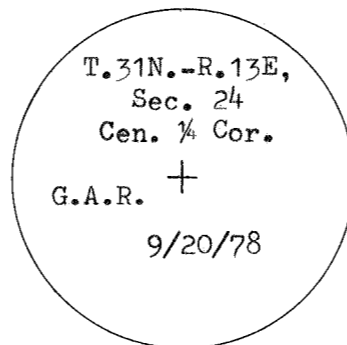

Gary A. Radtke

Dated at Antigo, Wis., this Twentieth day of September, 19 78.

Signature Gary A. Radtke Title Registered Land Surveyor Registration No. 1248
(County Surveyor, Registered Land Surveyor, or other duly authorized official)

Office of Register of Deeds, County of Lan glade, I hereby certify that the within instrument was filed in this office for record on the day of, 19..... at o'clock M.

.....
(Register of Deeds)

By..... Deputy