

CERTIFIED LAND CORNER RESTORATION

Index No. R-7

State of Wisconsin }
 County of LAUGHLIN } ss.

I WILLIAM F. KELLY, do hereby certify that on the 16th day of MAY, 1978, I found evidence of the S 1/4 corner of SECTION 20 Township 31, North, Range 12E, Fourth Principal Meridian, as described hereon; and that from this evidence I established a new monument and accessories as described hereon to perpetuate the original location of this corner.

Resident witnesses:

L. SOMAN

FORM 985 K. C. MILLER CO., MILWAUKEE

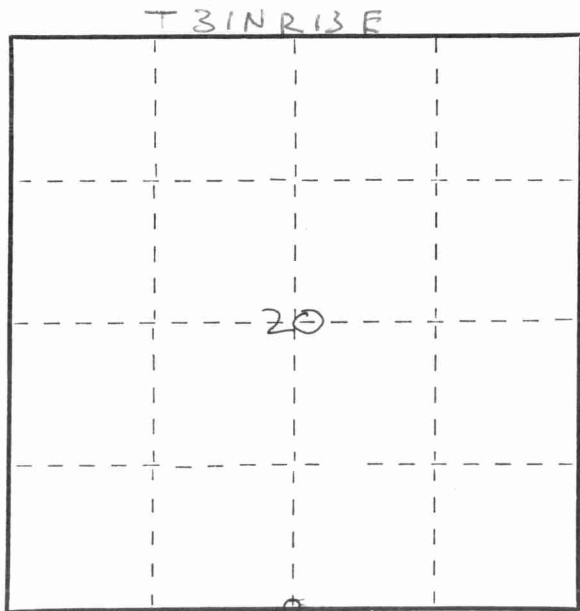

○ = Corner monument restored.

History of original corner establishment:

CORNER PREVIOUSLY ESTABLISHED BY R. HALLISY FROM 4x4 SCRIBED POST. BRASS CAP PIPE SET BY HALLISY WAS GONE BUT BEARING TREES WERE STILL IN PLACE

Description of corner evidence found:

SET NEW 1 1/2" x 42" IP WITH MARKED BRASS CAP AND REMARKED THE BEARING TREES CORNER IS IN A WET AREA 474 WOOD POST SCRIBED



William F. Kelly

Description of monument and accessories I established to perpetuate the original location of this corner.

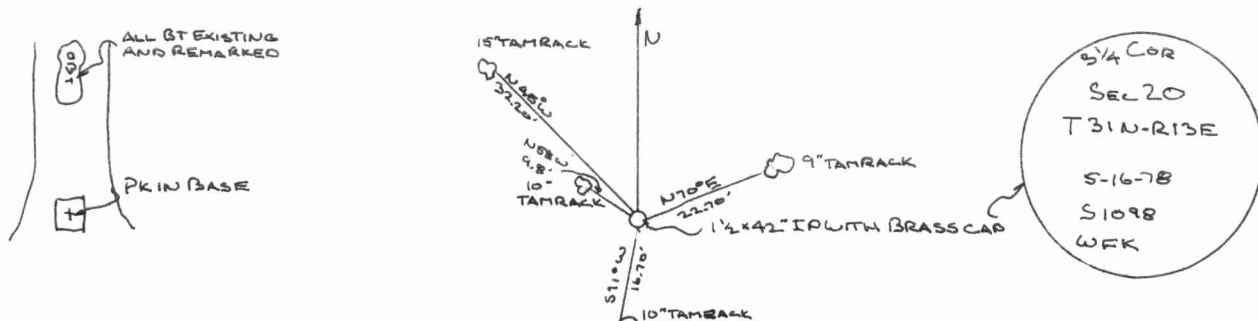

Dated at ELCHO, Wis., this 16th day of MAY, 1978

Signature William F. Kelly Title REGISTERED LAND SURVEYOR Registration No. S1098
 (County Surveyor, Registered Land Surveyor, or other duly authorized official)

Office of Register of Deeds, County of _____, I hereby certify that the within instrument was filed in this office for record on the _____ day of _____, 19____ at _____ o'clock _____ M.

(Register of Deeds)

By _____ Deputy

