

CERTIFIED LAND CORNER RESTORATION

Index No. L-11

State of Wisconsin }
County of Langlade } ss.

History of original corner establishment:

Old Notes

I Gary A. Radtke, do hereby certify that on the 5th day of October, 1978, I found evidence of the Center one-quarter corner of Sec. 16 Township 31 13, North, Range 13, Fourth Principal Meridian, as described hereon; and that from this evidence I established a new monument and accessories as described hereon to perpetuate the original location of this corner.

Description of corner evidence found:
Reset Corner by Survey



Gary A. Radtke

Resident witnesses:

.....
.....
.....

Description of monument and accessories I established to perpetuate the original location of this corner.

T.31.N.-R.13E. Sec. 16

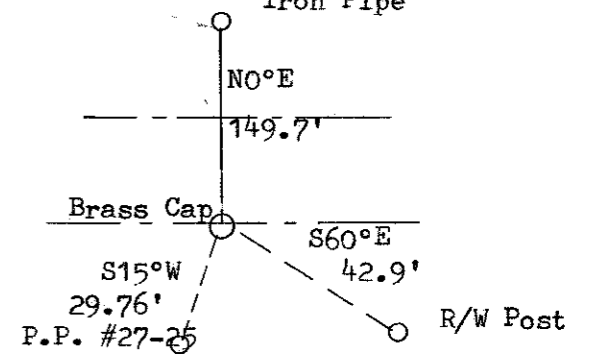
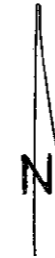
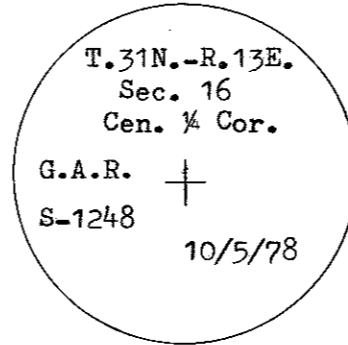
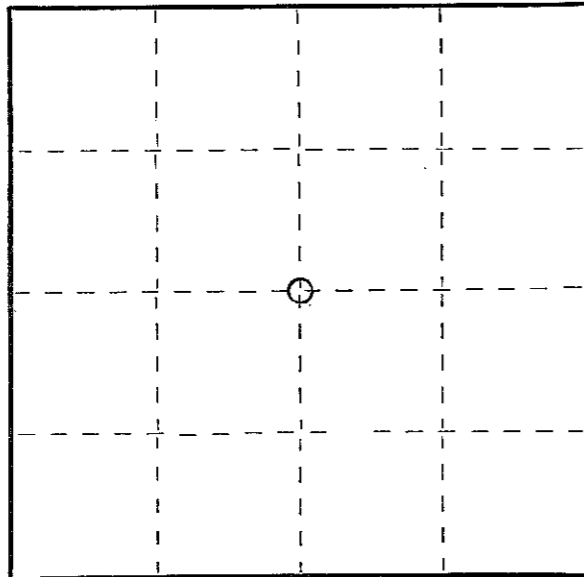

Dated at Antigo, Wis., this 5th day of October, 1978

Signature Gary A. Radtke Title Registered Land Surveyor Registration No. 1248
(County Surveyor, Registered Land Surveyor, or other duly authorized official)

Office of Register of Deeds, County of Langlade, I hereby certify that the within instrument was filed in this office for record on the _____ day of _____, 19____ at _____ o'clock _____ M.

(Register of Deeds)

By _____ Deputy

○ = Corner monument restored.

FORM 985 H. C. MILLER CO., MILWAUKEE