

CERTIFIED LAND CORNER RESTORATION

Index No. 2-21

State of Wisconsin }  
County of VILAS } ss.

I, F.H. COPP, do hereby certify that on the 6th day of August, 1980, I found evidence of the W 1/4 corner of Section 13 Township 31, North, Range 13 East, Fourth Principal Meridian, as described hereon; and that from this evidence I established a new monument and accessories as described hereon to perpetuate the original location of this corner.

Resident witnesses:

.....  
.....  
.....

History of original corner establishment:

Orig. BTs. Hemlock 10" N73W 46 lks  
Hemlock 24" N74E 38 lks

Description of corner evidence found: Deed recorded in volume 192 pages 197,198 at the Langlade Co. Court House at Antigo Wisconsin.  
Hiway map of Job #7982 Langlade Co. Dated 1937  
Field Notes of Job # 7982 Dated April 25 1934, surveyed by, C. Senn, F. Winat, C. Dvorak, A. Pizak, J. Margraf.  
Headpost south of S.T.H. "64"  
Spur Gear North of Head Post  
Remains of 1/8 corner South of W 1/4 corner, as called for in field notes of Job#7982  
Statement of Mr. Lewis Adkins an area resident for 66 years and one time owner of the SW 1/4 of Section 13 T31N R13E, that the North line of his property was near the centerline of the "old road" and that the new road (1937) is in the same location as the old.

Description of monument and accessories I established to perpetuate the original location of this corner.

Set 3/4" Iron Rod 2.70' north of centerline of S.T.H. "64" & 24.73' East of centerline of Grudgeville road.



Monuments. 2" Langlade Co type Brass Cap N00° 43' 05"E 51.72'  
BTs PJ 10" N22°W 26.47'  
PJ 10" N30°E 27.80'  
2" Langlade Co type Brass Cap S00° 43' 05"W 60.45'  
BTs Utility pole S65°W 51.82'

Norbert L. Vissers Crew Chief  
Kenneth V. Freund Assistant

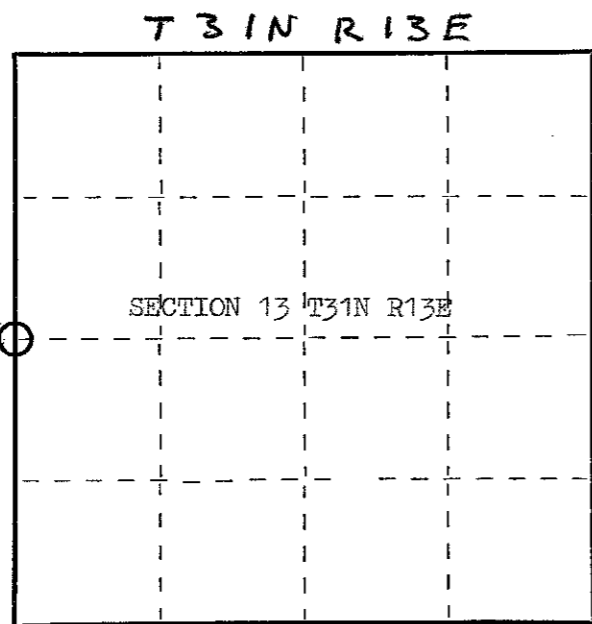

○ = Corner monument restored.

Dated at Border Junction, Wis., this 3rd day of September, 1980

Signature F. H. Copp Title Registered Land Surveyor Registration No. S-799  
(County Surveyor, Registered Land Surveyor, or other duly authorized official)

Office of Register of Deeds, County of....., I hereby certify that the within instrument was filed in this office for record on the.....day of....., 19..... at.....o'clock..... M.

(Register of Deeds)

By.....Deputy

FORM 985 R. C. MILLER CO., MILWAUKEE