

CERTIFIED LAND CORNER RESTORATION

Index No. S-1

State of Wisconsin }
County of Wood } ss.

I Keith R. Vreeland, do hereby certify that on the about 4th day of June, 1973, I found evidence of the Southwest corner of Section 7 Township 31 N, North, Range 14 E, Fourth, Principal Meridian, as described hereon; and that from this evidence I established a new monument and accessories as described hereon to perpetuate the original location of this corner.

Resident witnesses:
as shown on the tie sketch.

FORM 985 H. C. MILLER CO., MILWAUKEE

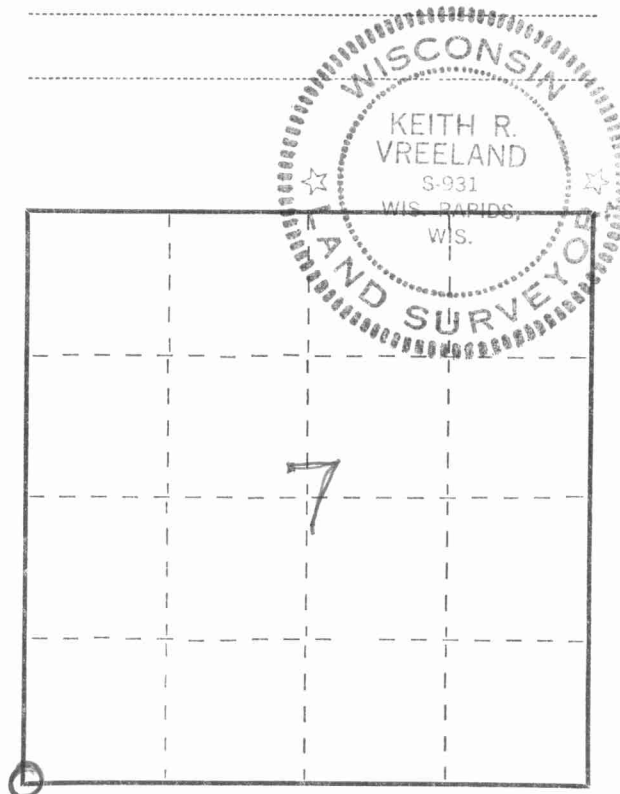

○ = Corner monument restored.

History of original corner establishment:

See History of retracement as stated on Index Number _____ for the Southeast corner of Section 7

Description of corner evidence found:

No evidence of original corner found. Old fence line to north and south. Logging road to south and east. Set corner to match evidence, measurements of proportionate methods and evidence from plats and aerial mapping.

Description of monument and accessories I established to perpetuate the original location of this corner.

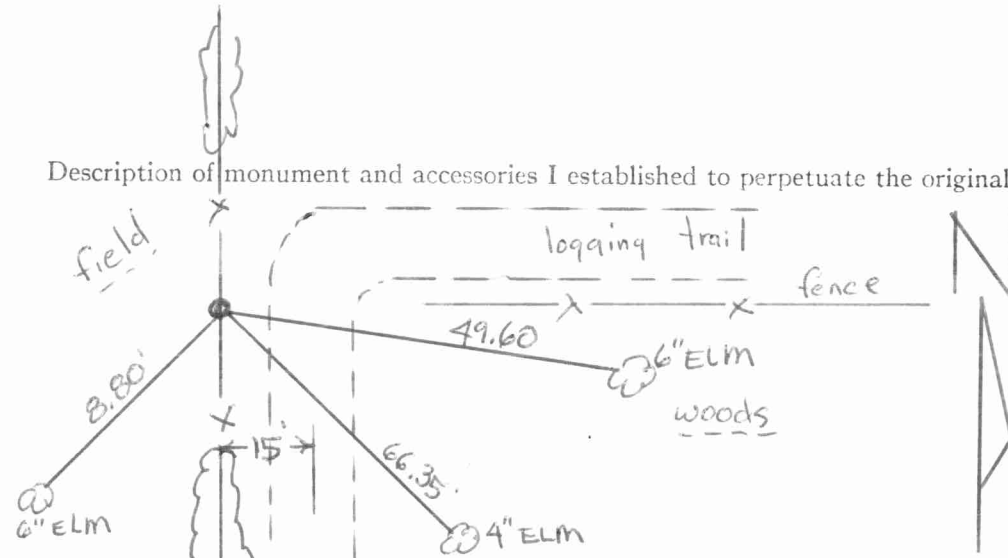

2"x30" iron pipe 3.65#/ft.
6" above ground. steel
fence post alongside.
Trees blazed, metal
tabs set. All
measurements horizontal.

Dated at Wis. Rapids, Wis, this 20th day of May, 19 75.

Signature Keith R. Vreeland Title Registered Land Surveyor Registration No. S-0931
(County Surveyor, Registered Land Surveyor, or other duly authorized official)

Office of Register of Deeds, County of _____, I hereby certify that the within instrument was filed in this office for record on the _____ day of _____, 19 _____ at _____ o'clock _____ M.

(Register of Deeds)

By _____ Deputy

