

CERTIFIED LAND CORNER RESTORATION

Index No. Z-19

State of Wisconsin }  
County of Lanlade } ss.

History of original corner establishment:  
**None**

I Gary A. Radtke, do hereby certify that on the 11th day of November, 1976, I found evidence of the S 1/4 corner of Section 35 Township 31, North, Range 12 East, Fourth Principal Meridian, as described hereon; and that from this evidence I established a new monument and accessories as described hereon to perpetuate the original location of this corner.

Description of corner evidence found:  
**Brass Cap lying on its side, set in 1939 by S.C.**

Resident witnesses:  
\_\_\_\_\_  
\_\_\_\_\_  
\_\_\_\_\_

Description of monument and accessories I established to perpetuate the original location of this corner.  
**Remonumented S1/4, set Brass Cap that was present and called out three BTs.**

FORM 985 H. C. MILLER CO., MILWAUKEE

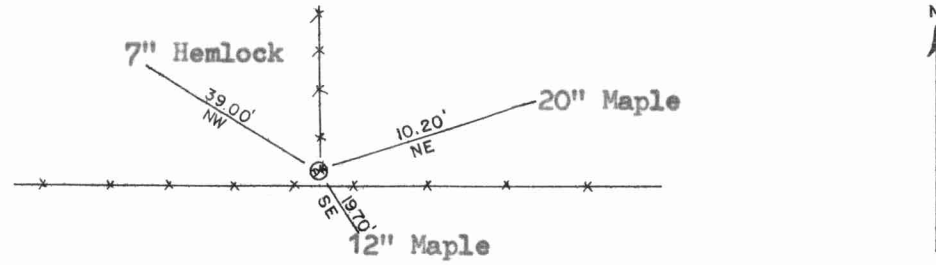
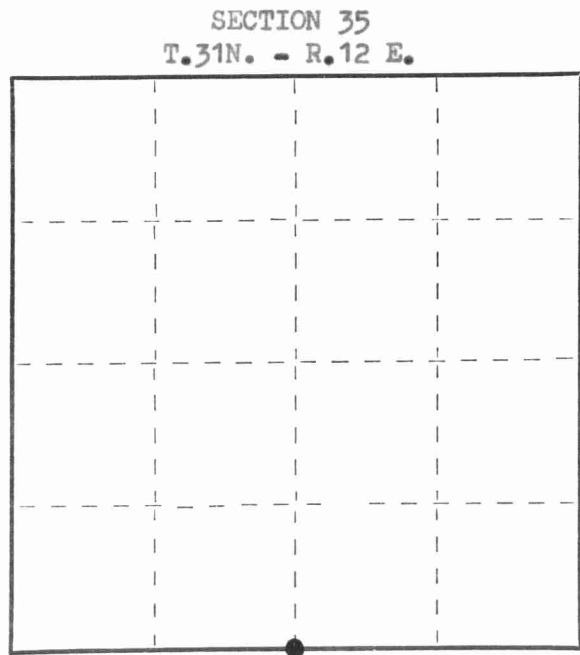

Dated at ANTIGO, Wis., this 10th day of December, 1976

Signature Gary A. Radtke Title Reg. Land Surveyor Registration No. S-1248  
(County Surveyor, Registered Land Surveyor, or other duly authorized official)

Office of Register of Deeds, County of \_\_\_\_\_, I hereby certify that the within instrument was filed in this office for record on the \_\_\_\_\_ day of \_\_\_\_\_, 19\_\_\_\_ at \_\_\_\_\_ o'clock \_\_\_\_\_ M.

\_\_\_\_\_  
(Register of Deeds)  
By \_\_\_\_\_ Deputy

○ = Corner monument restored.

