

CERTIFIED LAND CORNER RESTORATION

Index No. Z-17

State of Wisconsin }
County of Lenglade } ss.

I, Gary A. Radtke, do hereby certify that on the 11th day of November, 19 76, I found evidence of the Southwest corner of Section 35 Township 31, North, Range 1 East, Fourth Principal Meridian, as described hereon; and that from this evidence I established a new monument and accessories as described hereon to perpetuate the original location of this corner.

Resident witnesses:

.....
.....
.....

FORM 985 H. C. MILLER CO., MILWAUKEE

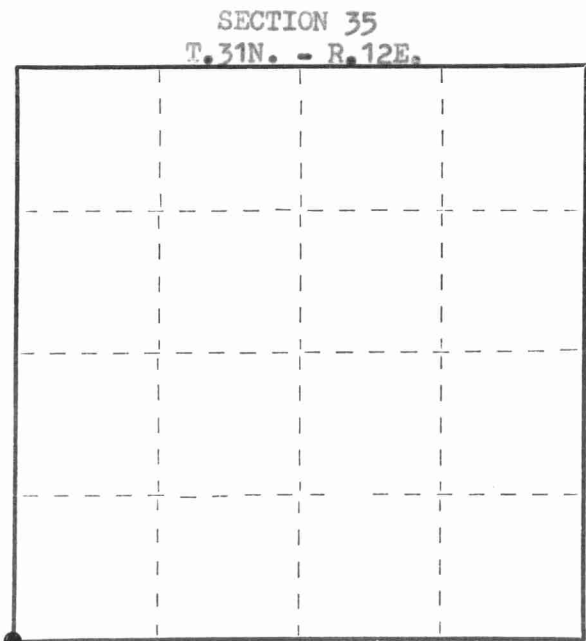

○ = Corner monument restored.

History of original corner establishment:

None

*5/22/96 D. TWIST
MON. ON SIDE HILL NORTH OF ROAD.
NEEDS TO BE STRAIGHTENED!*

Description of corner evidence found:

Brass Cap under ground, covered by sand and rocks, set in 1939 by S.C.

Description of monument and accessories I established to perpetuate the original location of this corner.

Remonumented SW Crn., leveled area around cap, set a rock barrier and called out three BTs.

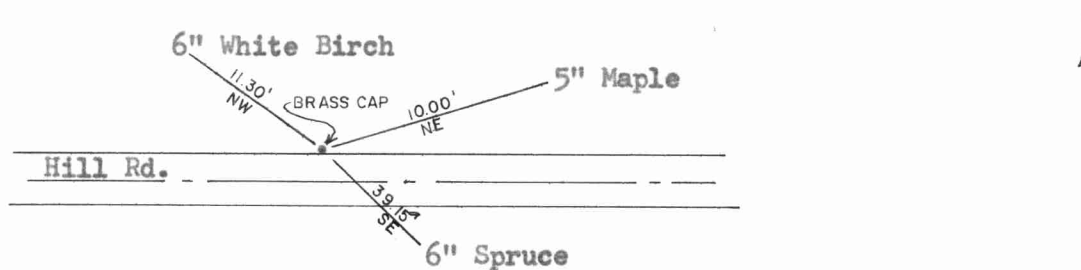

Dated at ANTIGO, Wis., this 10th day of December, 19 76

Signature Gary A. Radtke Title Reg. Land Surveyor Registration No. S-1248
(County Surveyor, Registered Land Surveyor, or other duly authorized official)

Office of Register of Deeds, County of _____, I hereby certify that the within instrument was filed in this office for record on the _____ day of _____, 19 _____ at _____ o'clock _____ M.

.....
(Register of Deeds)

By _____ Deputy

