

CERTIFIED LAND CORNER RESTORATION

31-12

Index No. T17

State of Wisconsin }  
 County of LANGLADE } ss.

I, ROBERT J. POSS, do hereby certify that on the 7<sup>TH</sup> day of JUNE, 1969, I found evidence of the 1/4 corner of SECS. 26 & 27 Township 31, North, Range R 12 E, Fourth, Principal Meridian, as described hereon; and that from this evidence I established a new monument and accessories as described hereon to perpetuate the original location of this corner.

Resident witnesses:

M. KOLPACK

History of original corner establishment:

Description of corner evidence found:

*STUMP of ORIGINAL B.T. IT WAS LISTED 8" W. MAPLE BY B.F. DORR HAD BEEN CUT AWAY TO REVEAL SCRIBE of ORIG. SURVEYOR. LISTED BY DORR AS S52 1/2 E-46, CHECKS O.K. WITH ROADS & FENCE LINES AT N52 1/2 W 46-SET MON. ACCORDINGLY.*

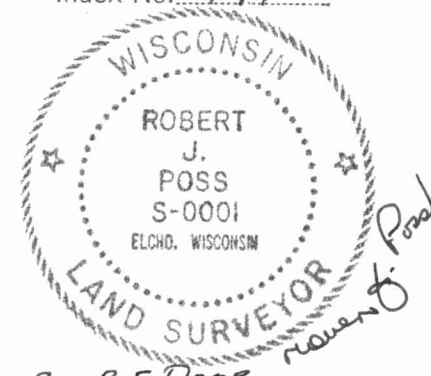

Description of monument and accessories I established to perpetuate the original location of this corner.

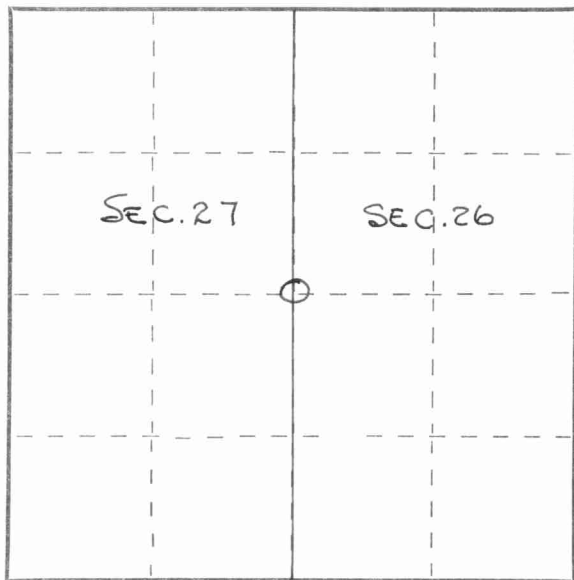
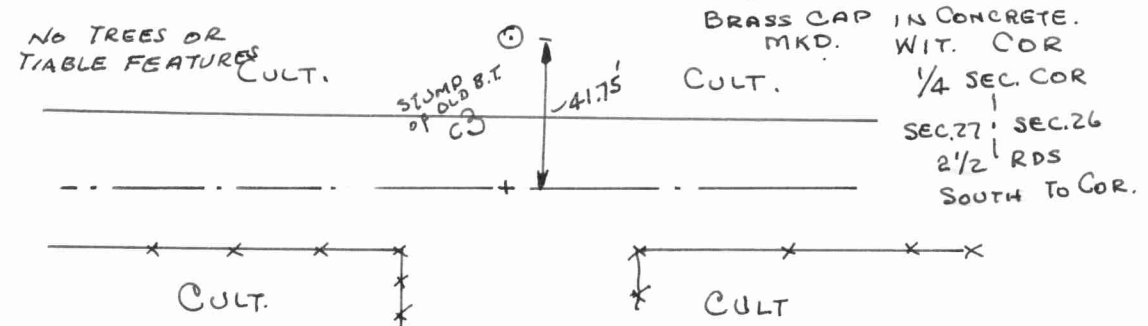

○ = Corner monument restored.

Dated at ELCHO, Wis., this 10<sup>TH</sup> day of JUNE, 1969.

Signature Robert J. Poss Title REG. LAND SURVEYOR Registration No. S-0001  
 (County Surveyor, Registered Land Surveyor, or other duly authorized official)

Office of Register of Deeds, County of \_\_\_\_\_, I hereby certify that the within instrument was filed in this office for record on the \_\_\_\_\_ day of \_\_\_\_\_, 19\_\_\_\_ at \_\_\_\_\_ o'clock \_\_\_\_\_ M.

(Register of Deeds)

By \_\_\_\_\_ Deputy

FORM 985 H. C. MILLER CO., MILWAUKEE

