

CERTIFIED LAND CORNER RESTORATION

31-12

Index No. R-17

State of Wisconsin }
County of LANGLADE } ss.

I ROBERT J. POSS, do hereby certify that on the 6TH day of JULY, 1969, I found evidence of the SECTION corner of SECS. 22-23-26-27 Township 31, North, Range 12 EAST, Fourth, Principal Meridian, as described hereon; and that from this evidence I established a new monument and accessories as described hereon to perpetuate the original location of this corner.

Resident witnesses:

M. KOLPACK

History of original corner establishment:

Description of corner evidence found:

KOLPACK FOUND ORIG. STAKE - BADLY ROTTED SO SET 12-INCH CEDAR POST IN SAME HOLE. NEW FENCE RUNS NORTH.

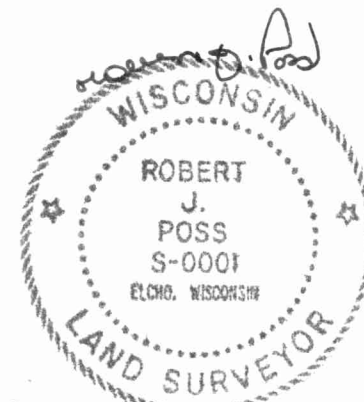

Description of monument and accessories I established to perpetuate the original location of this corner.

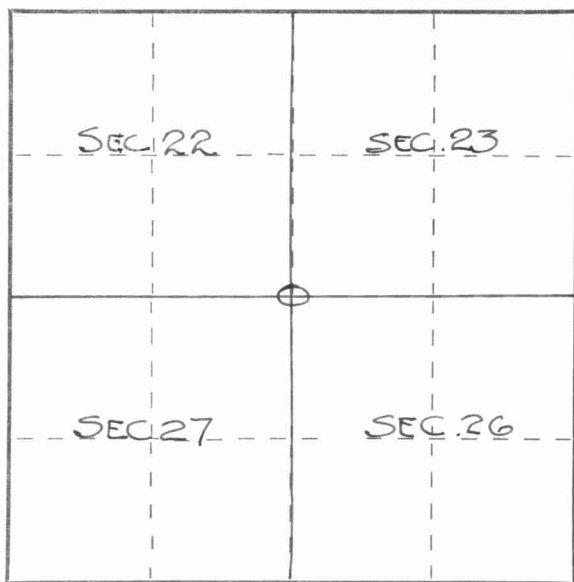

○ = Corner monument restored.

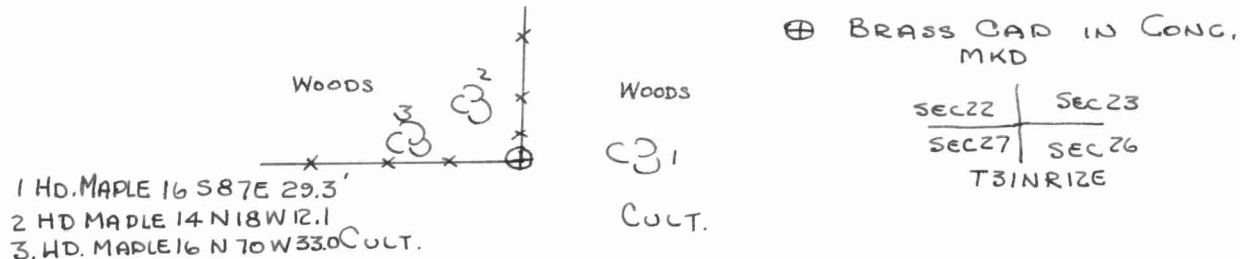

Dated at ELCHO, Wis., this 7TH day of JULY, 1969.

Signature Robert J. Poss Title REG. LAND SURVEYOR Registration No. S-0001
(County Surveyor, Registered Land Surveyor, or other duly authorized official)

Office of Register of Deeds, County of _____, I hereby certify that the within instrument was filed in this office for record on the _____ day of _____, 19____ at _____ o'clock _____ M.

(Register of Deeds)

By _____ Deputy

