

CERTIFIED LAND CORNER RESTORATION

Index No. R-9

State of Wisconsin }
County of Langlade } ss.

History of original corner establishment:
Found None.

I Gary A. Radtke, do hereby certify that on the 6th day of June, 1978, I found evidence of the SW corner corner of Section 21 Township 31, North, Range 12 East, Fourth Principal Meridian, as described hereon; and that from this evidence I established a new monument and accessories as described hereon to perpetuate the original location of this corner.

Description of corner evidence found:

Found existing Iron Pipe at intersection of the Q's of C.T.Y. Road "S" & Reimer Rd., 2" below surface.

Resident witnesses:



Description of monument and accessories I established to perpetuate the original location of this corner.

FORM 985 H. C. MILLER CO., MILWAUKEE

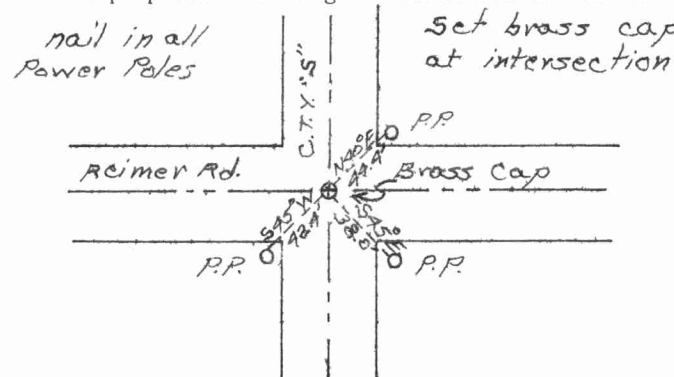
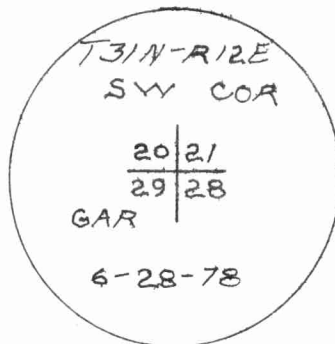
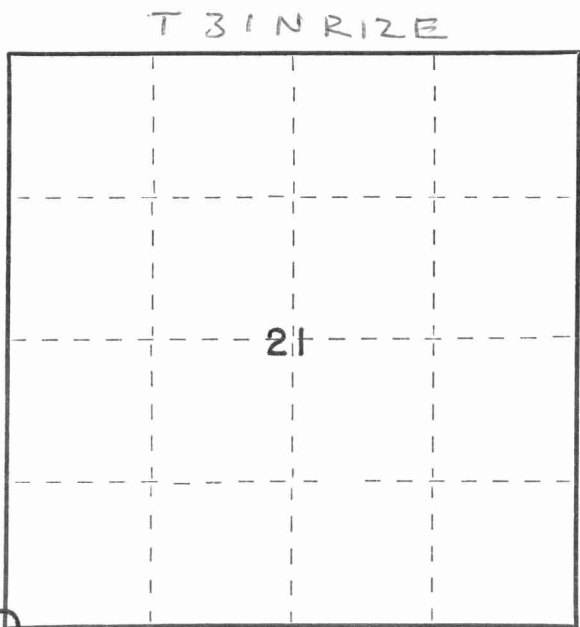

Dated at Antigo, Wis., this 6th day of July, 1978

Signature Gary A. Radtke Title Registered Land Surveyor Registration No. S-1248
(County Surveyor, Registered Land Surveyor, or other duly authorized official)

Office of Register of Deeds, County of _____, I hereby certify that the within instrument was filed in this office for record on the _____ day of _____, 19____ at _____ o'clock _____ M.

(Register of Deeds)

By _____ Deputy

○ = Corner monument restored.

