

CERTIFIED LAND CORNER RESTORATION

Index No. J-15

State of Wisconsin }
County of Langlade } ss.

History of original corner establishment:

Orig. by James McBride
Nov. 21 thru Dec. 1, 1857

Birch 8 S20W 24
Elm 12 N8E 31

I Thomas R. Arnott, do hereby
certify that on the 25 day
of July, 1981, I found
evidence of the 1/4
corner of sections 10 and 15
Township 31, North, Range
12 E, Fourth Principal Meridian,
as described hereon; and that from this evidence
I established a new monument and accessories
as described hereon to perpetuate the original
location of this corner.

Description of corner evidence found:

No evidence found.
Used fence line intersection and road centerline as best
possible location.

Resident witnesses:

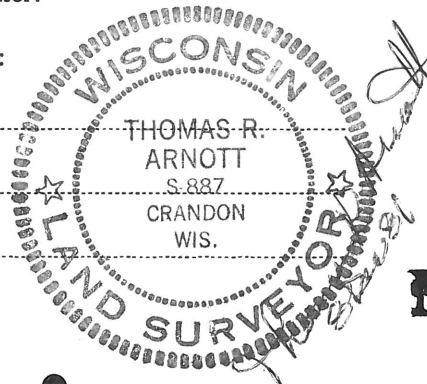

Description of monument and accessories I established to perpetuate the original location of this corner.

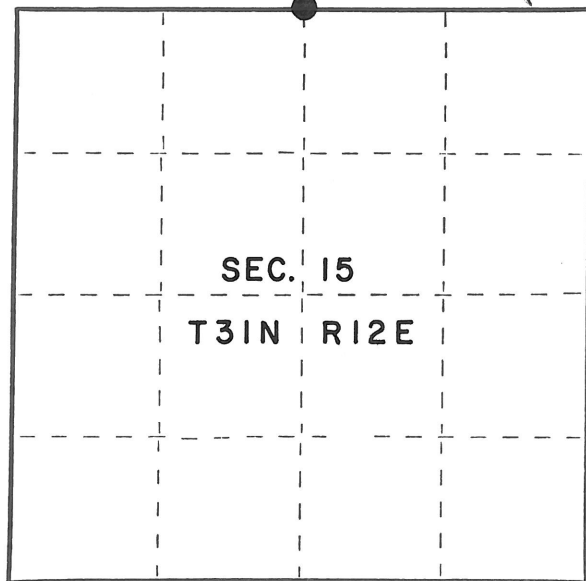
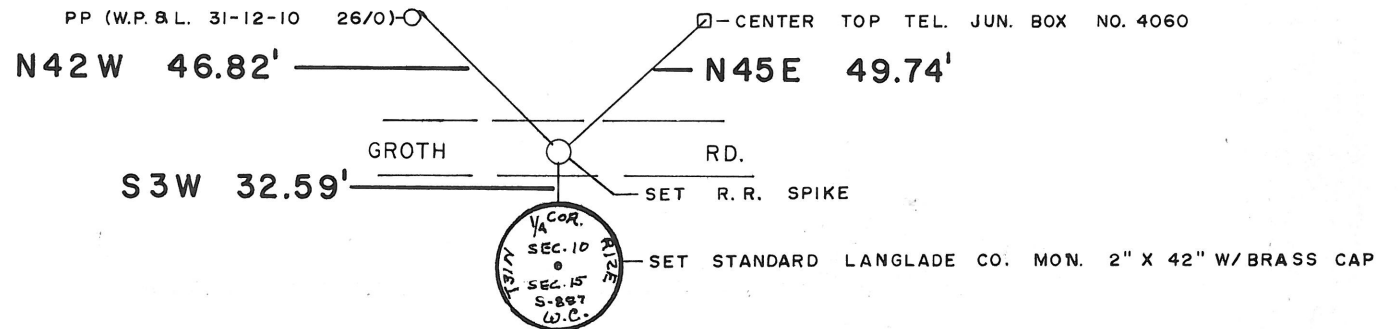

Dated at Crandon, Wis., this 8th day of December, 19 81.

Signature Thomas R. Arnott Title Surveyor Registration No. S-887
(County Surveyor, Registered Land Surveyor, or other duly authorized official)

Office of Register of Deeds, County of Langlade, I hereby certify that the within
instrument was filed in this office for record on the _____ day of _____, 19____
at _____ o'clock _____ M.

(Register of Deeds)

By _____ Deputy

○ = Corner monument restored.

FORM 985 H. C. MILLER CO., MILWAUKEE