

CERTIFIED LAND CORNER RESTORATION

31-11

Index No. Y-18

State of Wisconsin }
County of LANGLADE } ss.

I ROBERT J. POSS do hereby certify that on the 5TH day of JUNE, 1970, I found evidence of the S.W. 1/4 corner of SEC. 35 Township 31, North, Range 11 EAST, Fourth, Principal Meridian, as described hereon; and that from this evidence I established a new monument and accessories as described hereon to perpetuate the original location of this corner.

History of original corner establishment:



Description of corner evidence found:

FOUND 2"x2" GALV. L IRON - SET BY HUTCHINSON.

Resident witnesses:

WILEY PETROSKEY

Description of monument and accessories I established to perpetuate the original location of this corner.

SET 1/4" IRON PIPE PAINTED ORANGE W/BRASS CAP MKD.

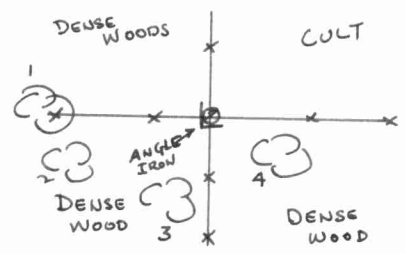

- 1 = HD. MAPLE 8 N 85 W 46.5 (WIRE IN TREE)
 - 2 = BIGGEST of TRIPLE BASSWOOD (SE) 10 S 59 W 15.0
 - 3 = HD. MAPLE 6 S 18 E 11.3
 - 4 = TWIN BASSWOOD 10 S 75 1/2 E 12.5
- ALL TREES BLAZED & SCRIBED NBT

SW 1/4 COR
SEC. 35
T31N R11E.

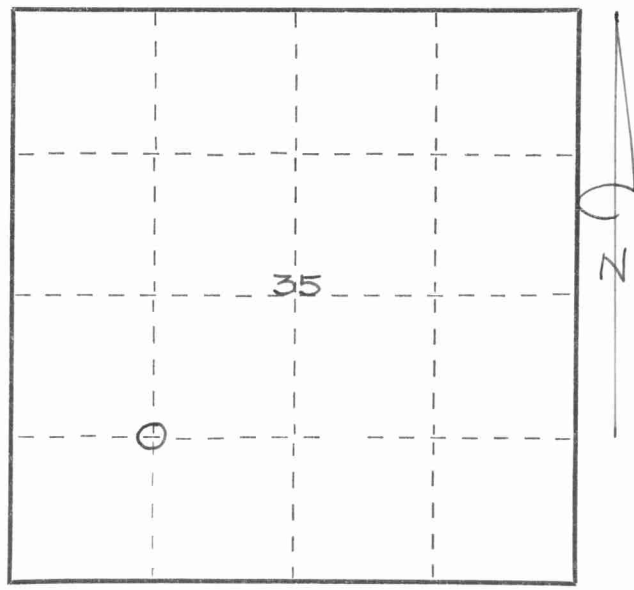

Dated at ELCHO, Wis., this 5TH day of JUNE, 1970.

Signature Robert J. Poss Title REG. LAND SURVEYOR Registration No. S-0001
(County Surveyor, Registered Land Surveyor, or other duly authorized official)

Office of Register of Deeds, County of _____, I hereby certify that the within instrument was filed in this office for record on the _____ day of _____, 19____ at _____ o'clock _____ M.

(Register of Deeds)

By _____ Deputy

○ = Corner monument restored.

FORM 985 H. C. MILLER CO., MILWAUKEE

4311351030

