

CERTIFIED LAND CORNER RESTORATION

Index No. W-7

State of Wisconsin }  
County of LANGLADE } ss.

I WM F. KELLY, do hereby certify that on the 31<sup>ST</sup> day of JULY, 1974, I found evidence of the NORTH 1/8 COR. ON N-S 1/4 LINE SEC. 32 Township 31, North, Range 11 EAST, Fourth Principal Meridian, as described hereon; and that from this evidence I established a new monument and accessories as described hereon to perpetuate the original location of this corner.

Resident witnesses:

.....  
.....  
.....

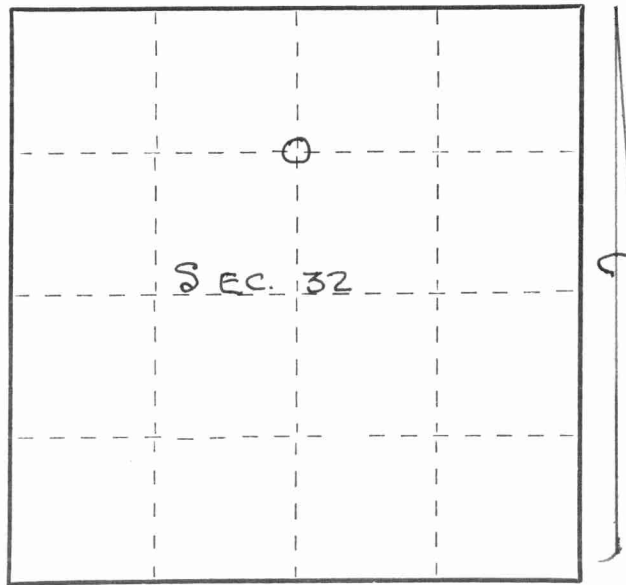

FORM 985 H. C. MILLER CO., MILWAUKEE 43/113a200

○ = Corner monument restored.

History of original corner establishment:

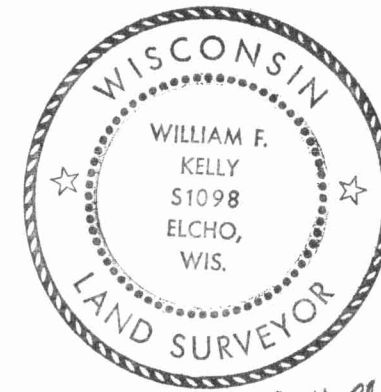

*William F. Kelly*

Description of corner evidence found:

LOCATED COR. FROM CITY NOTES. THAT REFERRED TO STONE MONUMENT WHEN SEWER LINES WERE INSTALLED.

Description of monument and accessories I established to perpetuate the original location of this corner.

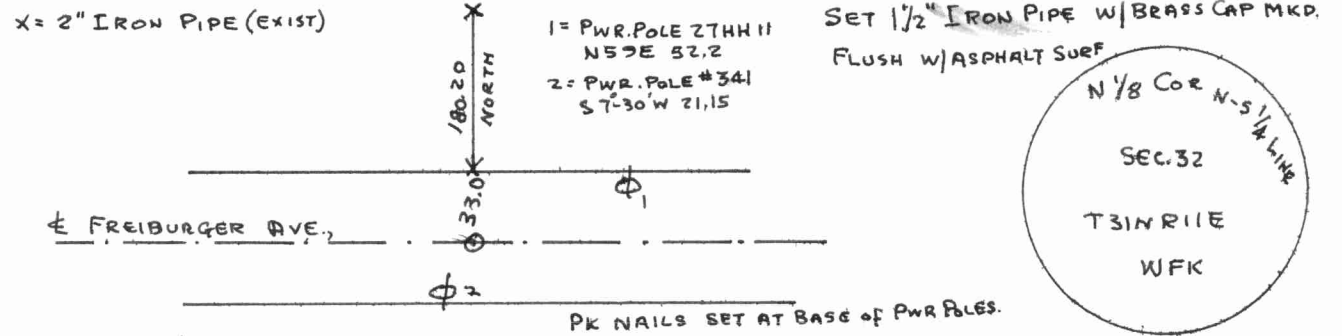

Dated at ELCHO, Wis., this 31<sup>ST</sup> day of JULY, 1974.

Signature William F. Kelly Title REG. LAND SURVEYOR Registration No. S-1098.  
(County Surveyor, Registered Land Surveyor, or other duly authorized official)

Office of Register of Deeds, County of \_\_\_\_\_, I hereby certify that the within instrument was filed in this office for record on the \_\_\_\_\_ day of \_\_\_\_\_, 19\_\_\_\_ at \_\_\_\_\_ o'clock \_\_\_\_\_ M.

.....  
(Register of Deeds)  
By.....Deputy

