

CERTIFIED LAND CORNER RESTORATION

Index No. U-2

State of Wisconsin }
County of LANGLADE } ss.

History of original corner establishment:

I W.M.F. KELLY, do hereby certify that on the 15TH day of OCTOBER, 1974, I found evidence of the SOUTHWEST 1/16 corner of SEC. 30 Township 31, North, Range 11 EAST, Fourth Principal Meridian, as described hereon; and that from this evidence I established a new monument and accessories as described hereon to perpetuate the original location of this corner.

Description of corner evidence found:
FOUND ORIGINAL STONE

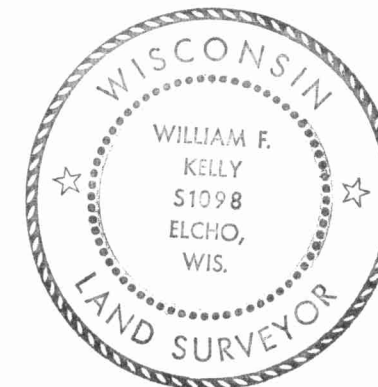

William F Kelly

Resident witnesses:

Description of monument and accessories I established to perpetuate the original location of this corner.

SET 1/2" IRON PIPE W/ BRASS CAP MKD.
AT SOUTHWEST COR. SUNSET ESTATES SUB-DIV

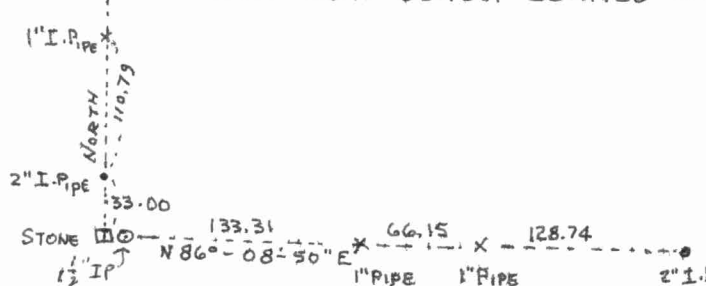

FORM 985 H. C. MILLER CO., MILWAUKEE

43111301030

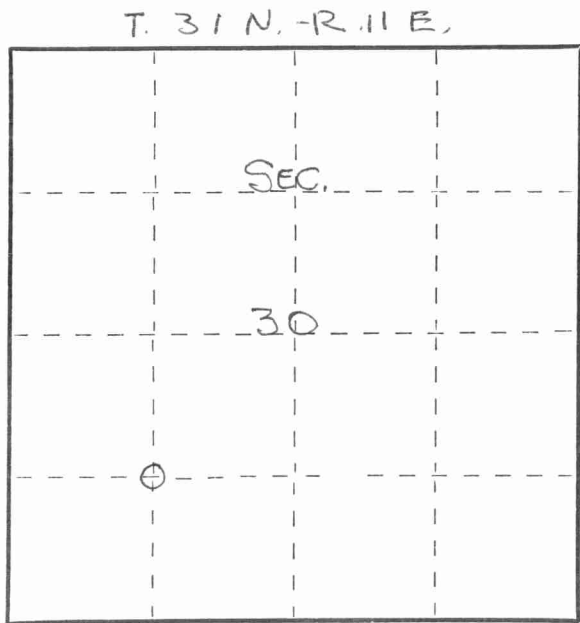

○ = Corner monument restored.

Dated at ELCHO, Wis., this 15TH day of OCTOBER, 1974

Signature William F. Kelly Title REG. LAND SURVEYOR Registration No. S-1098
(County Surveyor, Registered Land Surveyor, or other duly authorized official)

Office of Register of Deeds, County of _____, I hereby certify that the within instrument was filed in this office for record on the _____ day of _____, 19____ at _____ o'clock _____ M.

(Register of Deeds)

By _____ Deputy

