

CERTIFIED LAND CORNER RESTORATION

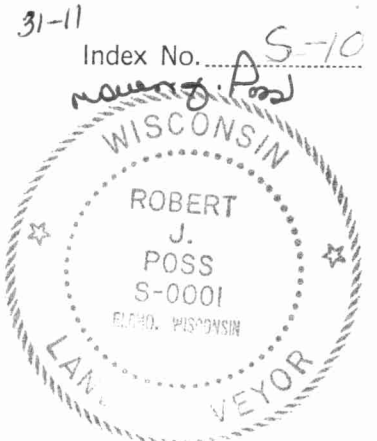

State of Wisconsin }
County of LANGLADE } ss.

I, ROBERT J. POSS, do hereby certify that on the 3RD day of JUNE, 1970, I found evidence of the N.W. 1/4 corner of SEC. 28 Township 31, North, Range 11 EAST, Fourth, Principal Meridian, as described hereon; and that from this evidence I established a new monument and accessories as described hereon to perpetuate the original location of this corner.

History of original corner establishment:

Description of corner evidence found:

DID NOT FIND STAKE; PART OF OLD BUGGY AXLE AT FENCES. CHAINED ACROSS TO 1/4 LINE. LOCATION CHECKS.

Resident witnesses:

.....
.....
.....

Description of monument and accessories I established to perpetuate the original location of this corner.

SET 1/4" PIPE PAINTED ORANGE. W/BRASS CAP MKD NW 1/4 COR SEC. 28 T 31 N 11 E.

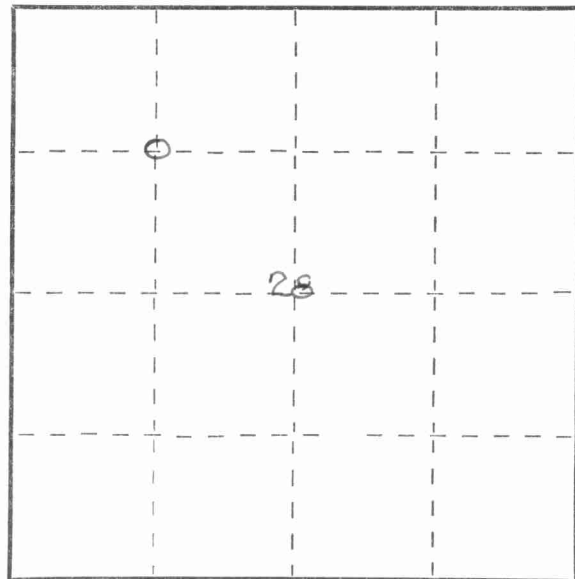
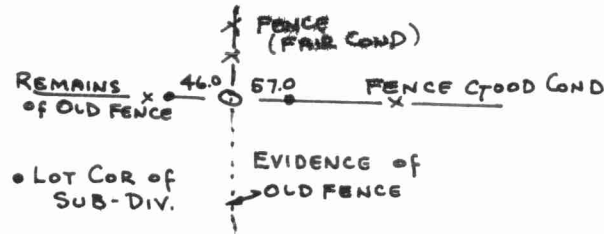

○ = Corner monument restored.

Dated at ELCHO, Wis., this 3RD day of JUNE, 1970.

Signature Robert J. Poss Title REG. LAND SURVEYOR Registration No. S-0001
(County Surveyor, Registered Land Surveyor, or other duly authorized official)

Office of Register of Deeds, County of _____, I hereby certify that the within instrument was filed in this office for record on the _____ day of _____, 19____ at _____ o'clock _____ M.

.....
(Register of Deeds)

By _____ Deputy

FORM 985 M. C. MILLER CO., MILWAUKEE

43111283030

