

CERTIFIED LAND CORNER RESTORATION

Index No. T-10

State of Wisconsin }  
 County of Langlade } ss.

I Daniel K. Pleoger, do hereby certify that on the 19th day of September, 1979, I found evidence of the North 1/16th corner of SW 1/4, Section 28, Township 31, North, Range 11 East, Fourth Principal Meridian, as described hereon; and that from this evidence I established a new monument and accessories as described hereon to perpetuate the original location of this corner.

Resident witnesses:

.....  
 .....  
 .....

History of original corner establishment:



Description of corner evidence found:

Found a 1" iron rod 14" below the top of the pavement. Top of rod was bent to the west, assumed corner was straight part of rod.

Set railroad spike over found iron rod.

Description of monument and accessories I established to perpetuate the original location of this corner.

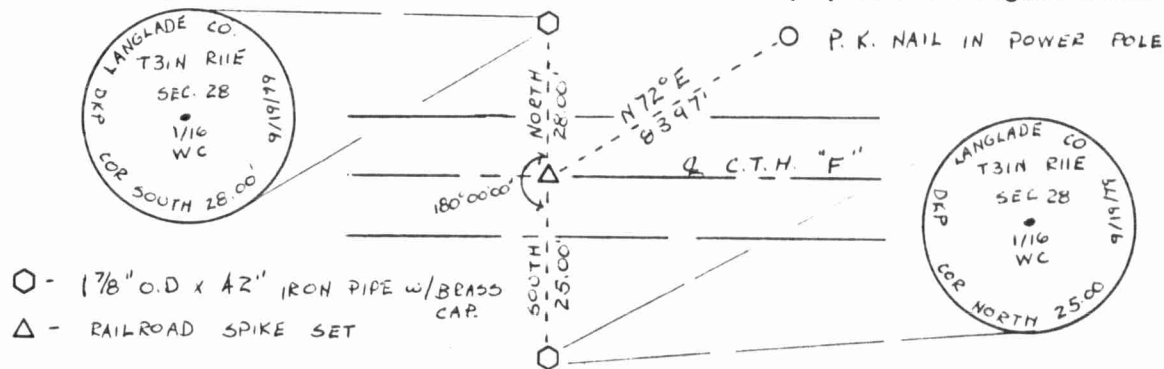
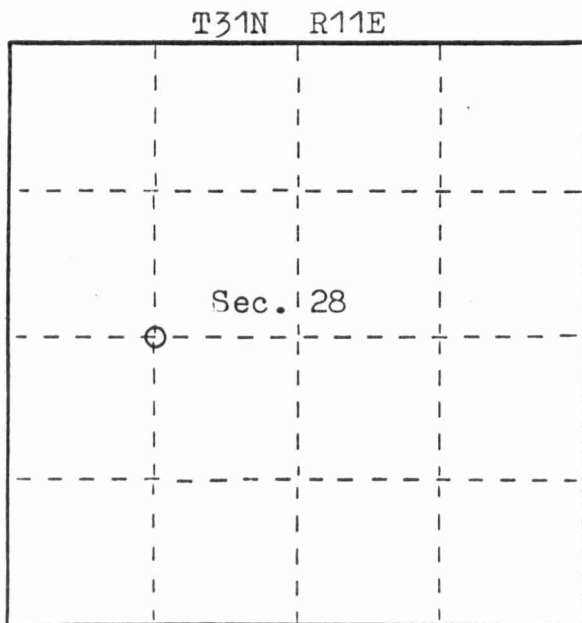

- - 1 7/8" O.D x 42" IRON PIPE w/ BRASS CAP.
- △ - RAILROAD SPIKE SET

Dated at Antigo, Wis., this 25th day of September, 1979

Signature Daniel K. Pleoger Title Registered Land Surveyor Registration No. 1537  
 (County Surveyor, Registered Land Surveyor, or other duly authorized official)

Office of Register of Deeds, County of ....., I hereby certify that the within instrument was filed in this office for record on the ..... day of ....., 19..... at ..... o'clock ..... M.

(Register of Deeds)

By ..... Deputy

FORM 985 M. C. MILLER CO., MILWAUKEE

4311188030

○ = Corner monument restored.

