

CERTIFIED LAND CORNER RESTORATION

Index No. T-16

State of Wisconsin }
County of LANGLEDE } ss.

History of original corner establishment:

I WILLIAM F. KELLY, do hereby certify that on the 11TH day of July, 1978, I found evidence of the EAST 1/8 corner of SECTION 27 Township 31 North, Range 11E, Fourth Principal Meridian, as described hereon; and that from this evidence I established a new monument and accessories as described hereon to perpetuate the original location of this corner.

Description of corner evidence found:
LOCATED EAST 1/8 CORNER FROM BECHER-HOPPE CONTROL SURVEY OF AIRPORT PROPERTY.
FOUND 1" IRON PIN IN PLACE.

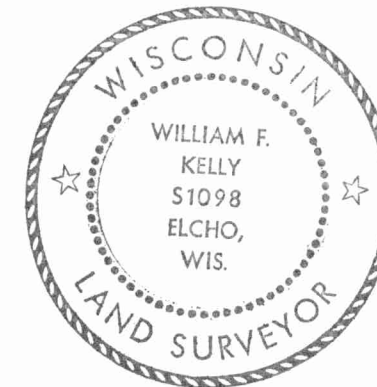

Resident witnesses:

Description of monument and accessories I established to perpetuate the original location of this corner.
SET WITNESS CORNERS.

FORM 983 H. C. MILLER CO., MILWAUKEE

4311127a010

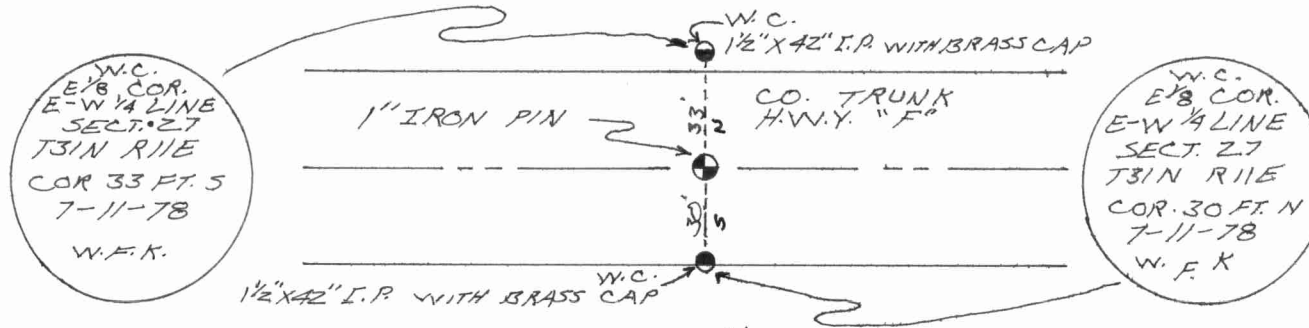
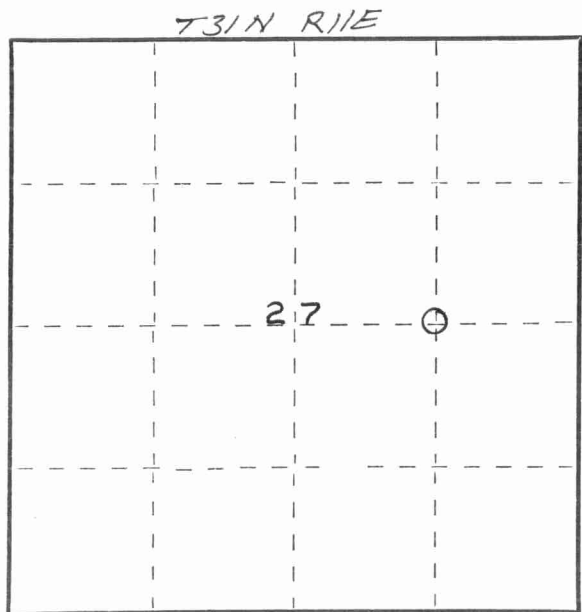

Dated at ELCHO, Wis., this 16th day of SEPTEMBER, 1978

Signature William F. Kelly Title County Surveyor Registration No. S 1098
(County Surveyor, Registered Land Surveyor, or other duly authorized official)

Office of Register of Deeds, County of _____, I hereby certify that the within instrument was filed in this office for record on the _____ day of _____, 19____ at _____ o'clock _____ M.

(Register of Deeds)

By _____ Deputy

○ = Corner monument restored.

