

CERTIFIED LAND CORNER RESTORATION

Index No. 0-14

State of Wisconsin }  
County of LAWGLADE } ss.

History of original corner establishment:

I WILLIAM F. KELLY, do hereby certify that on the 8<sup>th</sup> day of JULY, 1978, I found evidence of the NORTH-WEST 1/4 corner of SECTION 22 Township 31, North, Range R11E, Fourth Principal Meridian, as described hereon; and that from this evidence I established a new monument and accessories as described hereon to perpetuate the original location of this corner.

Description of corner evidence found:

FOUND A 1" IRON PIPE AND A WELL POINT FROM BECHER-HOPPE SURVEY OF AIRPORT PROPERTY.

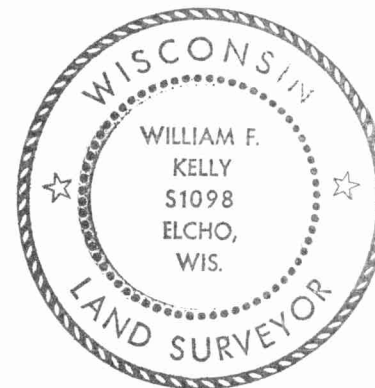

Resident witnesses:

NOTE:  
CORNER FALLS IN FIELD ON EAST SIDE OF RUNWAY.

Description of monument and accessories I established to perpetuate the original location of this corner.

FORM 985 H. C. MILLER CO., MILWAUKEE

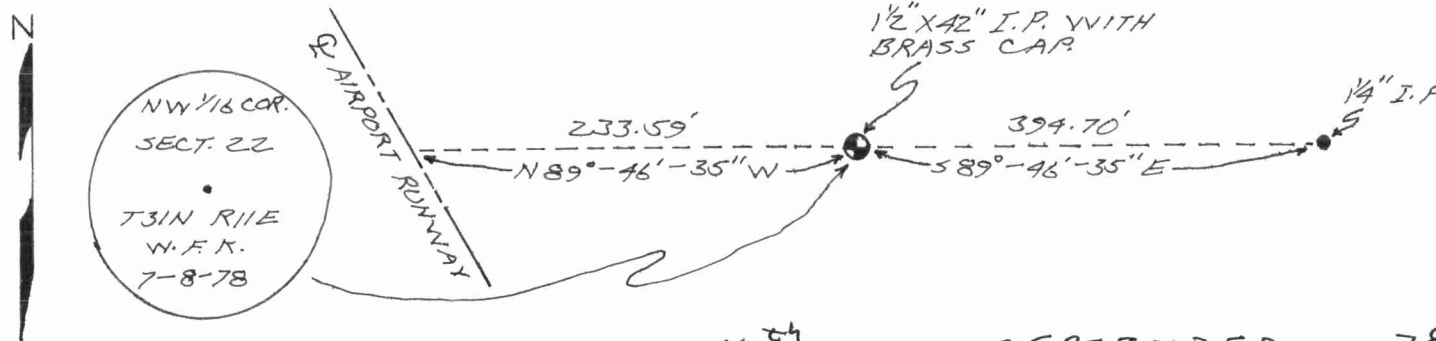
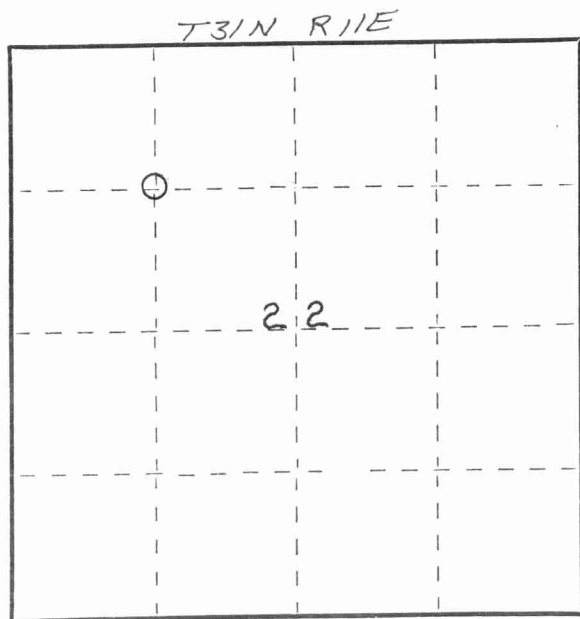

Dated at ELCHO, Wis., this 16<sup>th</sup> day of SEPTEMBER, 1978

Signature William F. Kelly Title County Surveyor Registration No. S 1098  
(County Surveyor, Registered Land Surveyor, or other duly authorized official)

Office of Register of Deeds, County of \_\_\_\_\_, I hereby certify that the within instrument was filed in this office for record on the \_\_\_\_\_ day of \_\_\_\_\_, 19\_\_\_\_ at \_\_\_\_\_ o'clock \_\_\_\_\_ M.

(Register of Deeds)

By \_\_\_\_\_ Deputy

○ = Corner monument restored.

43111223030

