

CERTIFIED LAND CORNER RESTORATION

Index No. Q-13

State of Wisconsin }  
County of LANGLADE } ss.

History of original corner establishment:

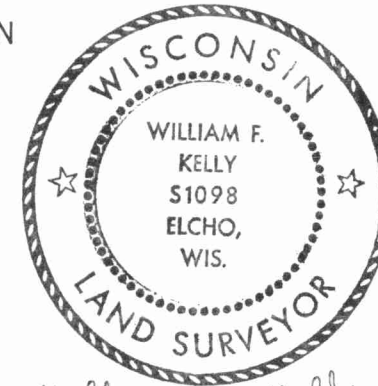

*William F. Kelly*

I WILLIAM F. KELLY, do hereby certify that on the 12<sup>TH</sup> day of JULY, 1978, I found evidence of the S 1/8 corner of SECTION 22 Township 31, North, Range 11E, Fourth Principal Meridian, as described hereon; and that from this evidence I established a new monument and accessories as described hereon to perpetuate the original location of this corner.

Description of corner evidence found:

LOCATED S 1/8 CORNER BETWEEN SECTIONS 21 & 22, T31N, R11E, FROM CONTROL SURVEY, RAN BY BECHORF & HOPPE FOR LANGLADE CO. AIRPORT. SET 1 1/2" X 42" IRON PIPE WITH BRASS CAP IN PLACE OF IRON PIPE FOUND.

Resident witnesses:

NOTE: CORNER IS ON A PRIVATE FIELD ROAD, WITH FIELDS ON ALL SIDES, CORNER IS 141.28 FEET, N01°41'05"W OF SW CORNER, SEC. 22, AND IS SET BELOW SURFACE OF ROAD.

Description of monument and accessories I established to perpetuate the original location of this corner.

FORM 985 H. C. MILLER CO., MILWAUKEE

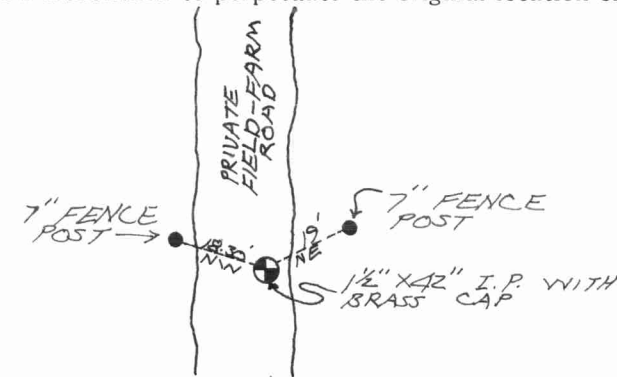
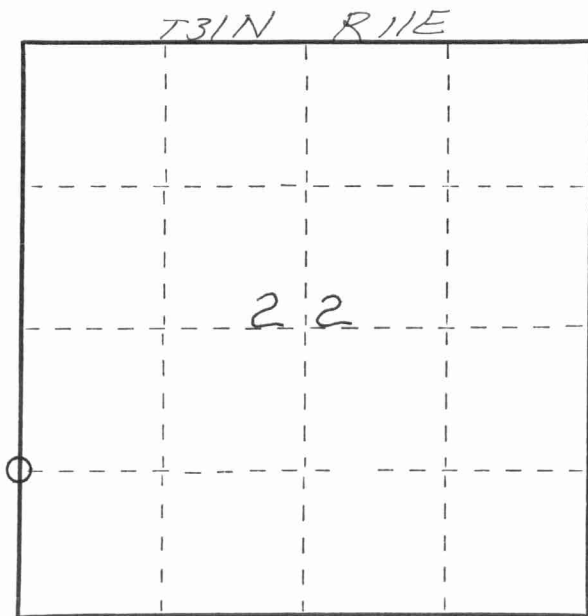

Dated at ELCHO, Wis., this 6<sup>TH</sup> day of OCTOBER, 1978.

Signature William F. Kelly Title COUNTY SURVEYOR Registration No. S-1098  
(County Surveyor, Registered Land Surveyor, or other duly authorized official)

Office of Register of Deeds, County of \_\_\_\_\_, I hereby certify that the within instrument was filed in this office for record on the \_\_\_\_\_ day of \_\_\_\_\_, 19\_\_\_\_ at \_\_\_\_\_ o'clock \_\_\_\_\_ M.

(Register of Deeds)

By \_\_\_\_\_ Deputy

○ = Corner monument restored.

431114

