

CERTIFIED LAND CORNER RESTORATION

Index No. Q-3

State of Wisconsin }
County of Langlade } ss.

I Gary A. Radtke, do hereby certify that on the 13th day of December, 1977, I found evidence of the S 1/8 on N-S Center Line corner of Section 19 Township 31 North, Range 11E, Fourth Principal Meridian, as described hereon; and that from this evidence I established a new monument and accessories as described hereon to perpetuate the original location of this corner.

Resident witnesses:

Patrick Vander Leest

History of original corner establishment:

Re-divided complete Section 19, T31N, R11E

Description of corner evidence found:



Description of monument and accessories I established to perpetuate the original location of this corner.

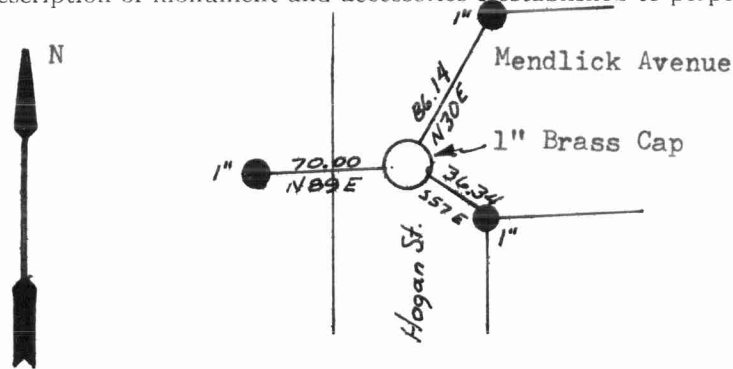

Brass Cap Marked

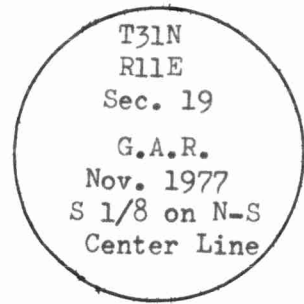

FORM 985 H. C. MILLER CO., MILWAUKEE

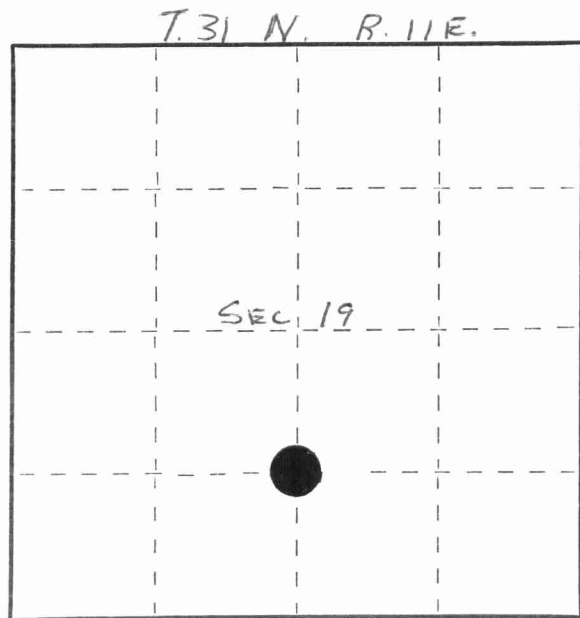

○ = Corner monument restored.

Dated at Antigo, Wis., this 14th day of December, 1977

Signature: Gary A. Radtke Title: Registered Land Surveyor Registration No. S-1248

Office of Register of Deeds, County of Langlade, I hereby certify that the within instrument was filed in this office for record on the day of 19 at o'clock M.

(Register of Deeds)

By Deputy

4311191020

