

CERTIFIED LAND CORNER RESTORATION

Index No. R-4

State of Wisconsin }
County of Langlade } ss.

History of original corner establishment:

Re-divided complete Section 19, T31n, R11E

I Gary A. Radtke, do hereby certify that on the 13th. day of December, 1977, I found evidence of the E 1/8 on S. Line corner of Section 19 Township 11E, North, Range _____, Fourth Principal Meridian, as described hereon; and that from this evidence I established a new monument and accessories as described hereon to perpetuate the original location of this corner.

Description of corner evidence found:

Resident witnesses:

Patrick Vander Leest



Description of monument and accessories I established to perpetuate the original location of this corner.

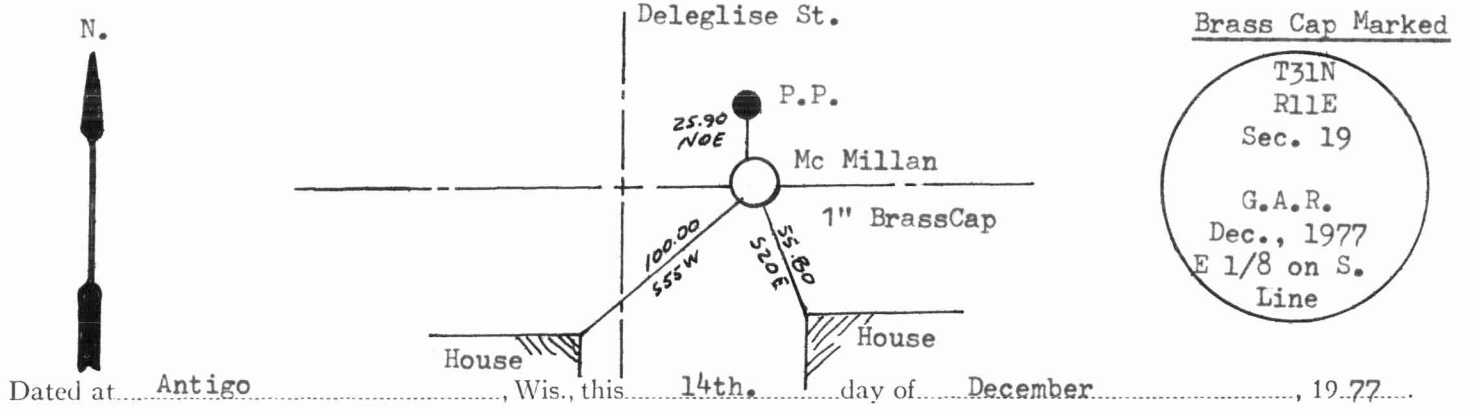
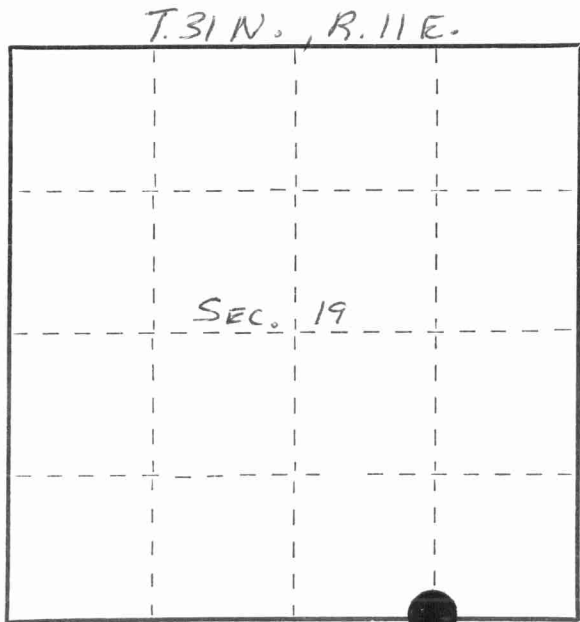

Dated at Antigo, Wis., this 14th. day of December, 1977

Signature Gary A. Radtke Title Registered Land Surveyor Registration No. S-1248
(County Surveyor, Registered Land Surveyor, or other duly authorized official)

Office of Register of Deeds, County of Langlade, I hereby certify that the within instrument was filed in this office for record on the _____ day of _____, 19____ at _____ o'clock _____ M.

(Register of Deeds)

By _____ Deputy

FORM 985 H. C. MILLER CO., MILWAUKEE 4311190010

○ = Corner monument restored.

