

CERTIFIED LAND CORNER RESTORATION

Index No. N-4

State of Wisconsin }
 County of Langlade } ss.

History of original corner establishment:

Re-divided Complete Section 19, T31N, R11E

I Gary A. Radtke, do hereby certify that on the 13th. day of December, 1977, I found evidence of the E 1/8 on N. Line corner of Section 19 Township 31, North, Range 11E, Fourth Principal Meridian, as described hereon; and that from this evidence I established a new monument and accessories as described hereon to perpetuate the original location of this corner.

Description of corner evidence found:

Resident witnesses:

Patrick Vander Leest

Description of monument and accessories I established to perpetuate the original location of this corner.

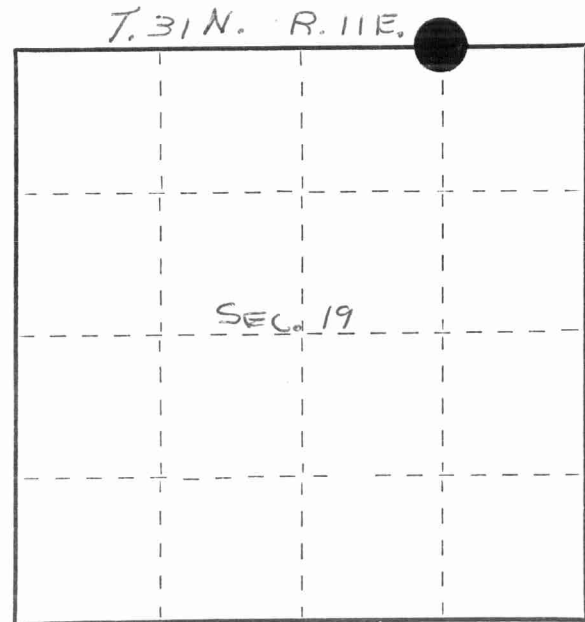

○ = Corner monument restored.

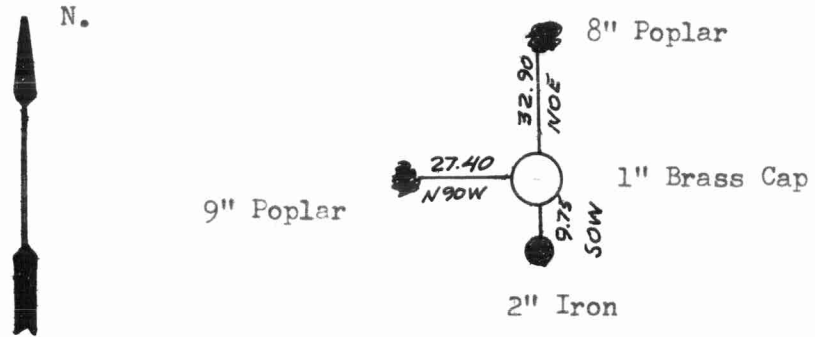

Brass Cap Marked

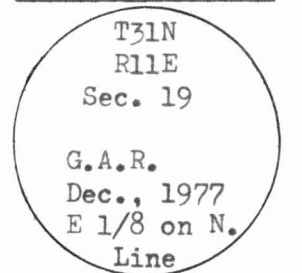

Dated at Antigo, Wis., this 14th. day of December, 1977.

Signature Gary A. Radtke Title Registered Land Surveyor Registration No. S-1248
 (County Surveyor, Registered Land Surveyor, or other duly authorized official)

Office of Register of Deeds, County of Langlade, I hereby certify that the within instrument was filed in this office for record on the _____ day of _____, 19____ at _____ o'clock _____ M.

(Register of Deeds)

By _____ Deputy

FORM 985 H. C. MILLER CO., MILWAUKEE

4311190010

