

CERTIFIED LAND CORNER RESTORATION

Index No. N-10

State of Wisconsin }  
 County of LANGLADE } ss.

I WESLEY J. TRADEWELL, do hereby certify that on the 19<sup>TH</sup> day of JUNE, 19 79, I found evidence of the NORTHEAST corner of N.W. 1/4, N.W. 1/4, SECTION 21, Township 31, North, Range 11 EAST, Fourth Principal Meridian, as described hereon; and that from this evidence I established a new monument and accessories as described hereon to perpetuate the original location of this corner.

Resident witnesses:  
 \_\_\_\_\_  
 \_\_\_\_\_  
 \_\_\_\_\_



Description of corner evidence found:

FOUND R.R. SPIKE, CORNER CHECKED GOOD FOR LINE AND DISTANCE BETWEEN NW CORNER AND N 1/4 CORNER OF SECTION 21.

Description of monument and accessories I established to perpetuate the original location of this corner.

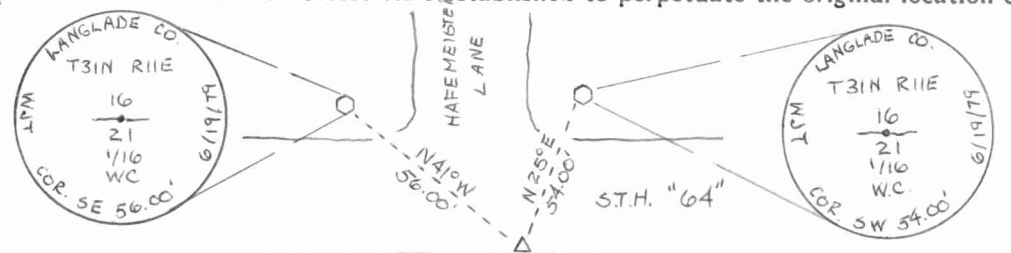
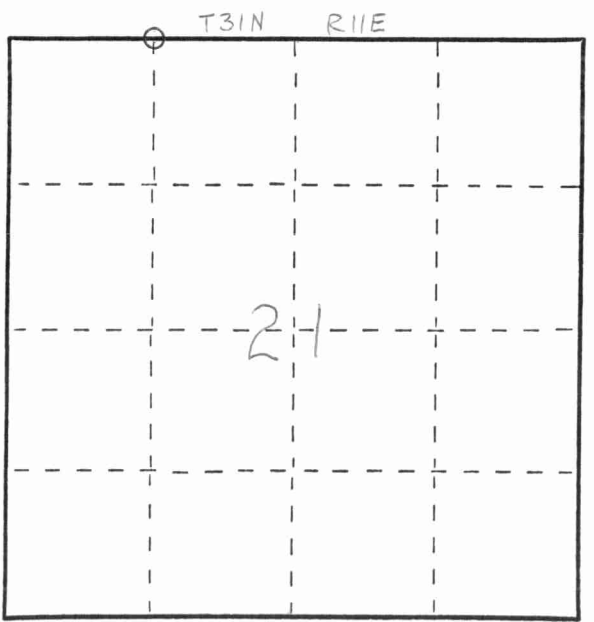

NOTE: BEARINGS TAKEN WITH RECON COMPASS

- △ - RAILROAD SPIKE FOUND
- - 1" IRON PIPE FOUND
- - 1 7/8" O.D. x 42" B.I.P. w/ BRASS CAP SET

Dated at ANTIGO, Wis., this 20<sup>TH</sup> day of JUNE, 19 79.

Signature Wesley J. Tradewell Title REGISTERED LAND SURVEYOR Registration No. 1342  
 (County Surveyor, Registered Land Surveyor, or other duly authorized official)

Office of Register of Deeds, County of \_\_\_\_\_, I hereby certify that the within instrument was filed in this office for record on the \_\_\_\_\_ day of \_\_\_\_\_, 19 \_\_\_\_\_ at \_\_\_\_\_ o'clock \_\_\_\_\_ M.

(Register of Deeds)

By \_\_\_\_\_ Deputy

FORM 985 M. C. MILLER CO., MILWAUKEE 4311110030

○ = Corner monument restored.

