

CERTIFIED LAND CORNER RESTORATION

31-10
Index No. N-11

State of Wisconsin }
County of LANGLADE } ss.

I, ROBERT J. POSS, do hereby certify that on the 12TH day of JULY, 1969, I found evidence of the 1/4 SEC. corner of SECS. 16 & 21 Township 31, North, Range 10E, Fourth, Principal Meridian, as described hereon; and that from this evidence I established a new monument and accessories as described hereon to perpetuate the original location of this corner.

Resident witnesses:

.....
.....
.....

Description of corner evidence found:

IRON PIPE BY HUTCHINSON (1938)

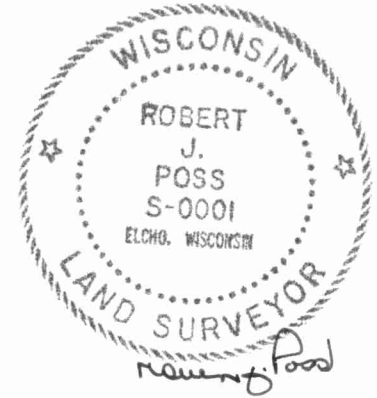

Description of monument and accessories I established to perpetuate the original location of this corner.

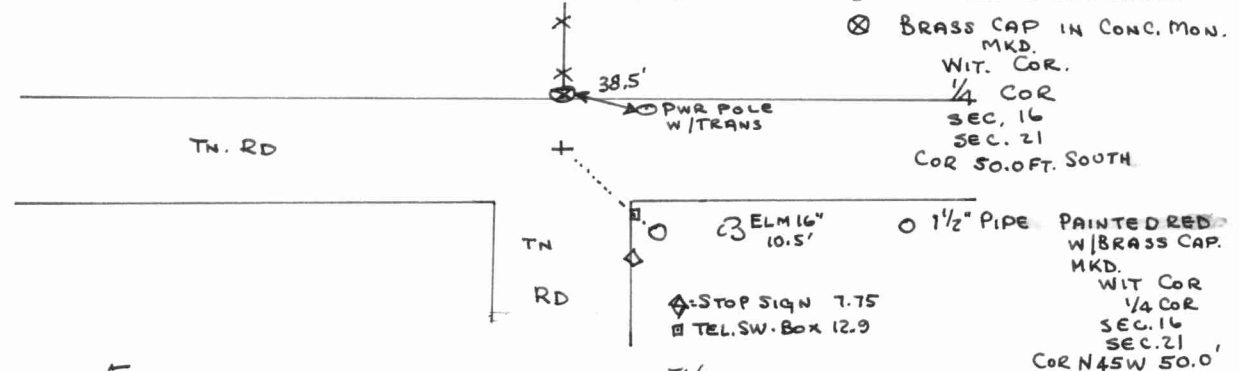

Dated at ELCHO, Wis., this 12TH day of JULY, 1969.

Signature Robert J. Poss Title REG. LAND SURVEYOR Registration No. S-0001
(County Surveyor, Registered Land Surveyor, or other duly authorized official)

Office of Register of Deeds, County of _____, I hereby certify that the within instrument was filed in this office for record on the _____ day of _____, 19____ at _____ o'clock _____ M.

.....
(Register of Deeds)
By _____ Deputy

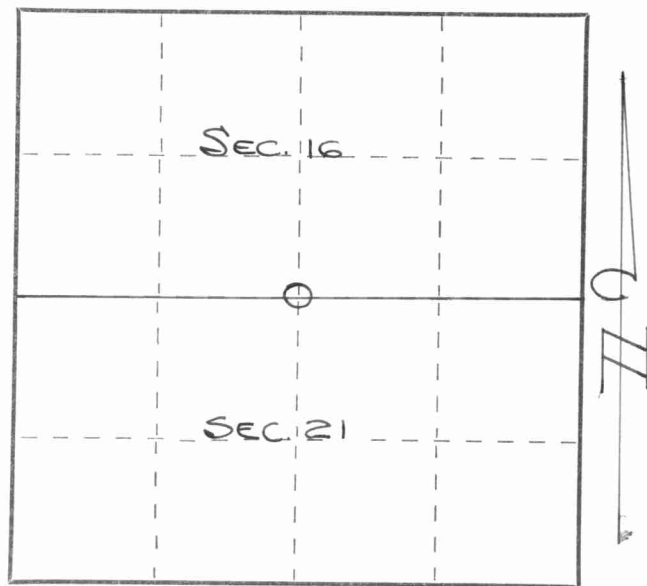

○ = Corner monument restored.

FORM 985 H. C. MILLER CO., MILWAUKEE

43110160020