

CERTIFIED LAND CORNER RESTORATION

31-10  
Index No. C-25

State of Wisconsin }  
County of LANGLADE } ss.

I, ROBERT J. POSS, do hereby certify that on the 5TH day of JULY, 1969, I found evidence of the 1/4 COR - corner of SECS. 1 & 6 Township 31 NORTH, North, Range 10 & 11 EAST, Fourth, Principal Meridian, as described hereon; and that from this evidence I established a new monument and accessories as described hereon to perpetuate the original location of this corner.

History of original corner establishment:

Description of corner evidence found:

IRON PIPE - FOUND WITH DIP NEEDLE  
CONFIRMED BY MATUSZEWSKI & BLASCZYK,



Resident witnesses:

JOHN MATUSZEWSKI

JOSEPH BLASCZYK

Description of monument and accessories I established to perpetuate the original location of this corner.

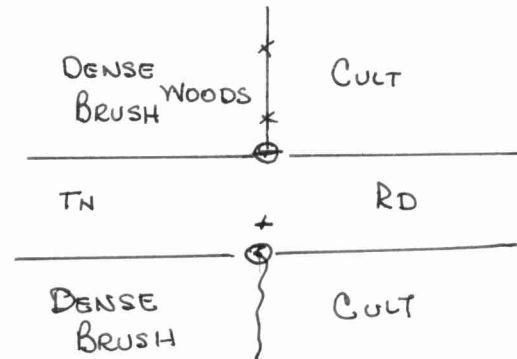
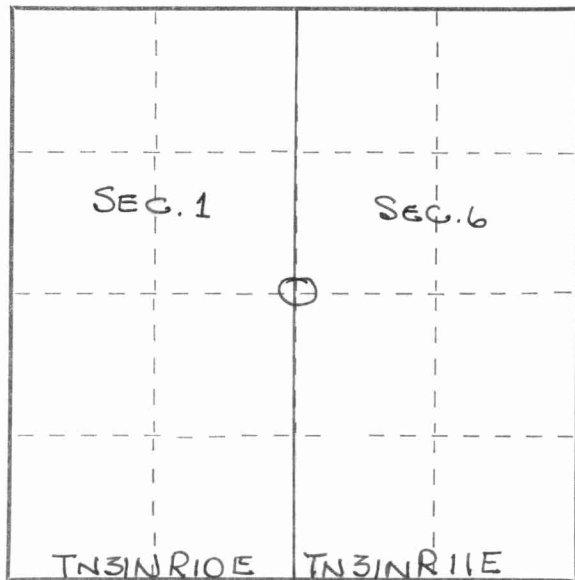

⊙ 1/4" PIPE W/GAL. CAP  
MKD.  
WIT COR  
1/4 COR  
SEC. 1 SEC. 6  
T31N  
R10E R11E  
33 FT. NORTH SOUTH TO COR.

Dated at ELCHO, Wis., this 5TH day of JULY, 1969.

Signature Robert J. Poss Title REG. LAND SURVEYOR Registration No. S-0001  
(County Surveyor, Registered Land Surveyor, or other duly authorized official)

Office of Register of Deeds, County of \_\_\_\_\_, I hereby certify that the within instrument was filed in this office for record on the \_\_\_\_\_ day of \_\_\_\_\_, 19\_\_\_\_ at \_\_\_\_\_ o'clock \_\_\_\_\_ M.

(Register of Deeds)

By \_\_\_\_\_ Deputy

○ = Corner monument restored.

FORM 985 H. C. MILLER CO., MILWAUKEE

4311001000