

CERTIFIED LAND CORNER RESTORATION

Index No. 2-19

State of Wisconsin }
County of Langlade } ss.

I Raymond J. Hallisy, do hereby certify that on the 30th day of October, 1976, I found evidence of the 1/4 corner of Section 35 Township 31, North, Range 9E, Fourth Principal Meridian, as described hereon; and that from this evidence I established a new monument and accessories as described hereon to perpetuate the original location of this corner.

Resident witnesses:

.....
.....
.....

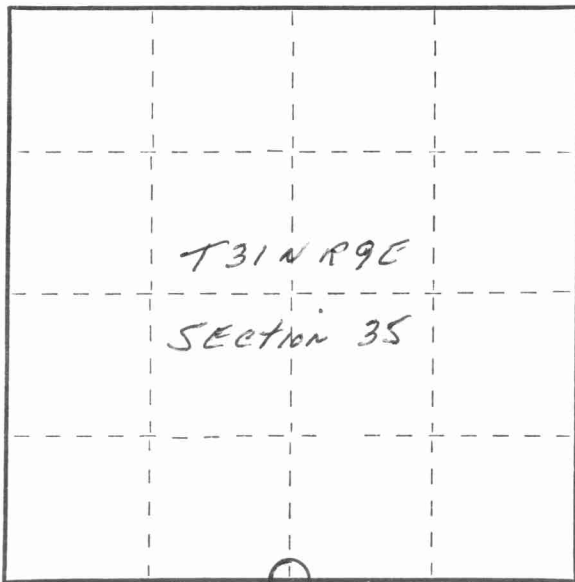

○ = Corner monument restored.

History of original corner establishment:

Corner set in the 1930 resurvey

Description of corner evidence found:

~~XXX~~

4" iron pipe with brass cap
Corner sets about 10ft. North of old road. No trees nearby.

Description of monument and accessories I established to perpetuate the original location of this corner.

Set a 7" steel fence post alongside the brass cap, with a location poster attached.

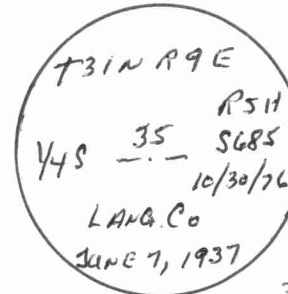

Dated at Antigo, Wis., this 30th day of October, 1976

Signature Raymond J. Hallisy Title Land Surveyor Registration No. S685
(County Surveyor, Registered Land Surveyor, or other duly authorized official)

Office of Register of Deeds, County of _____, I hereby certify that the within instrument was filed in this office for record on the _____ day of _____, 19____ at _____ o'clock _____ M.

.....
(Register of Deeds)

By _____ Deputy

FORM 985 H. C. MILLER CO., MILWAUKEE
4310935000