

CERTIFIED LAND CORNER RESTORATION

Index No. Z-15

State of Wisconsin }
County of Laporte } ss.

I Anthony B. Kiedrowski, do hereby certify that on the 8th day of February, 1978, I found evidence of the S 1/4 corner of Section 34 Township 31, North, Range 9, Fourth Principal Meridian, as described hereon; and that from this evidence I established a new monument and accessories as described hereon to perpetuate the original location of this corner.

Resident witnesses:

.....
.....
.....

History of original corner establishment:

June, 1851, James Marsh set post for the original corner.
June, 1937, D.A. Hintz set a 3" iron pipe with a brass cap.

Description of corner evidence found:

Found existing 3" iron pipe with a brass cap after an extensive traverse was run with a T/2 and EDM to determine search areas.

Description of monument and accessories I established to perpetuate the original location of this corner:

See reverse side.

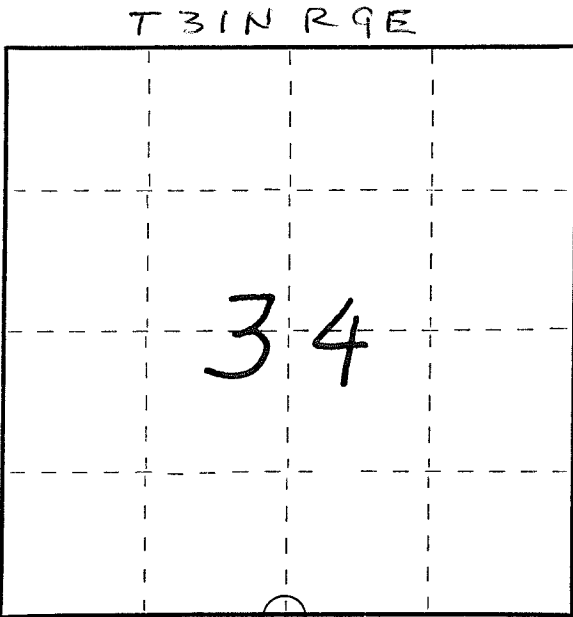

○ = Corner monument restored.

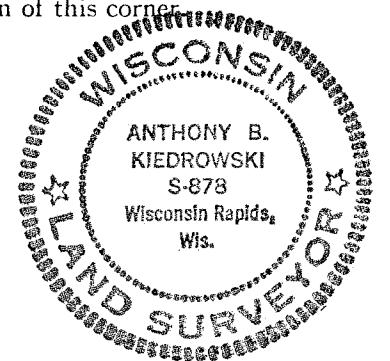

Dated at Wisconsin Rapids, Wis., this 21st day of February, 1978.

Signature Anthony B. Kiedrowski Title R.L.S. Registration No. 878
(County Surveyor, Registered Land Surveyor, or other duly authorized official)

Office of Register of Deeds, County of....., I hereby certify that the within instrument was filed in this office for record on the.....day of....., 19..... at.....o'clock..... M.

.....
(Register of Deeds)
By.....Deputy

FORM 985 H. C. MILLER CO., MILWAUKEE
43109340020

43109340020

Ties are to nail and disc driven into tree.

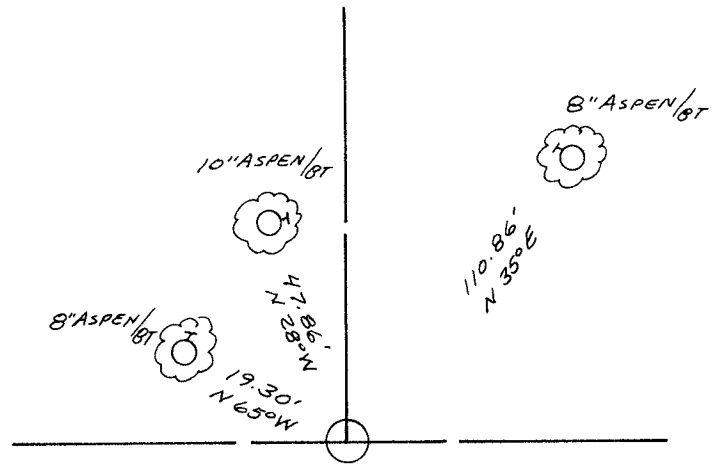

CUT-OVER AREA