

CERTIFIED LAND CORNER RESTORATION

Index No. D-21

State of Wisconsin }
County of Langlade } ss.

History of original corner establishment:

Corner set in the 1930 resurvey.

I Raymond J. Hallisy, do hereby certify that on the 28th day of May, 1978, I found evidence of the S 1/16 corner of Section 1 & 2 Township 31, North, Range 9E, Fourth Principal Meridian, as described hereon; and that from this evidence I established a new monument and accessories as described hereon to perpetuate the original location of this corner.

Description of corner evidence found:

Found marked wood post down.

Resident witnesses:

Description of monument and accessories I established to perpetuate the original location of this corner.

Set 2" iron pipe with brass cap.

New BT's

- 9" Aspen NW 29.4 Links
- 5" Red Maple N73E 28.8 Links
- 7" Aspen S87W 33.7 Links

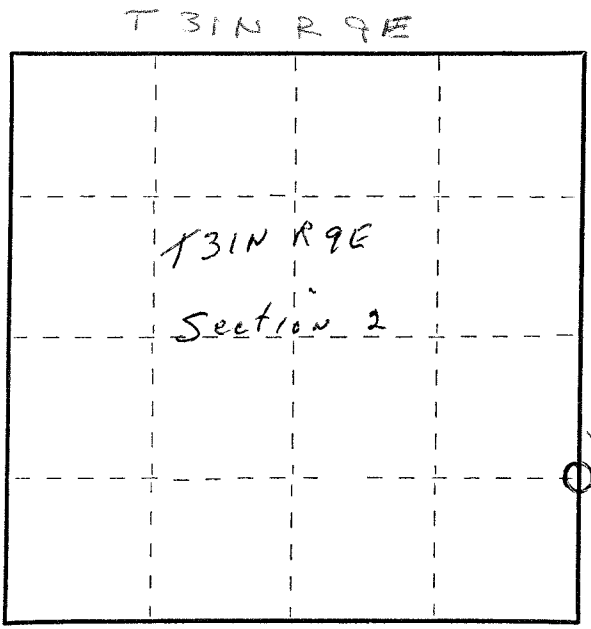
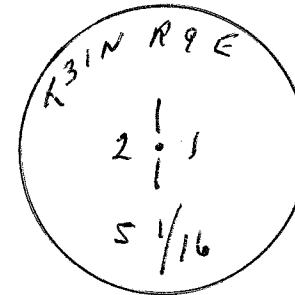

○ = Corner monument restored.

Dated at Antigo, Wis., this 28th day of May, 1978

Signature Raymond J. Hallisy Title Land Surveyor Registration No. S-685
(County Surveyor, Registered Land Surveyor, or other duly authorized official)

Office of Register of Deeds, County of _____, I hereby certify that the within instrument was filed in this office for record on the _____ day of _____, 19____ at _____ o'clock _____ M.

(Register of Deeds)

By _____ Deputy

FORM 985 H. C. MILLER CO., MILWAUKEE

4369021000