

CERTIFIED LAND CORNER RESTORATION

Index No. E-23

State of Wisconsin }
County of Langlade } ss.

History of original corner establishment:

Corner Established in 1937 Resurvey

31-9

I Raymond J. Hallisy, do hereby certify that on the 8th day of April, 1978, I found evidence of the North 1/4 corner of Section 12 Township 31, North, Range 9 EAST, Fourth Principal Meridian, as described hereon; and that from this evidence I established a new monument and accessories as described hereon to perpetuate the original location of this corner.

Description of corner evidence found:

4 inch Iron Pipe With Brass Cap
old Fence North and East

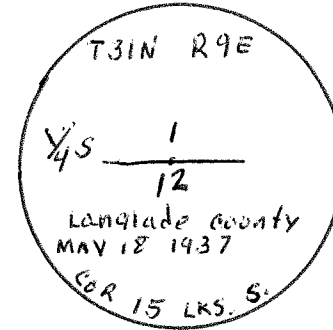

Resident witnesses:

Description of monument and accessories I established to perpetuate the original location of this corner.

New B.Tip

- Elm 7" N85°E 10 FT. 3 inchs
- Elm 8" S9°E 52 FT. 10 inchs
- oak 9" N78°W 54 FT.

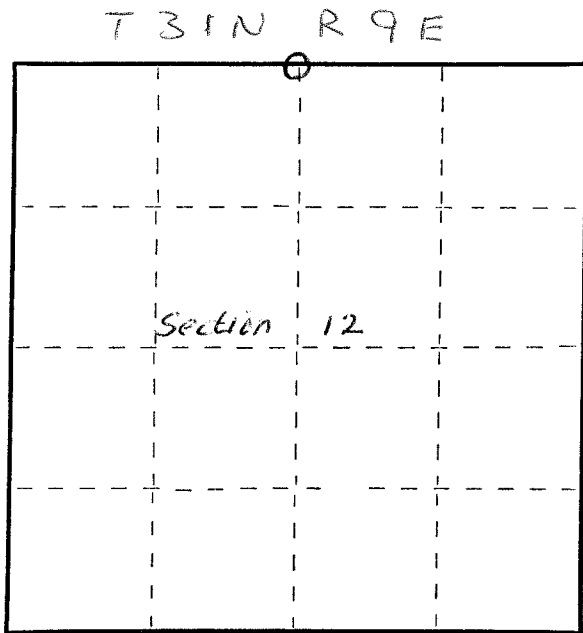

Dated at Antigo, Wis., this 8th day of April, 1978

Signature Raymond J. Hallisy Title Registered Land Surveyor Registration No. 5685
(County Surveyor, Registered Land Surveyor, or other duly authorized official)

Office of Register of Deeds, County of _____, I hereby certify that the within instrument was filed in this office for record on the _____ day of _____, 19____ at _____ o'clock _____ M.

(Register of Deeds)

By _____ Deputy

○ = Corner monument restored.

FORM 985 H. C. MILLER CO., MILWAUKEE

43109010000