

CERTIFIED LAND CORNER RESTORATION

Index No. Z-1

State of Wisconsin }
County of LANGLADE } ss.

History of original corner establishment:

June 22, 1851- James Marsh set wood post for the corner to R 8 & 9E on the Third Correction Line.

I ANTHONY B. KIEDROWSKI, do hereby certify that on the ELEVENTH day of OCTOBER, 1977, I found evidence of the Southwest corner of Section 31 Township 31, North, Range 9 E, Fourth Principal Meridian, as described hereon; and that from this evidence I established a new monument and accessories as described hereon to perpetuate the original location of this corner.

Description of corner evidence found:

SEE REVERSE SIDE

Resident witnesses:

.....
.....
.....

Description of monument and accessories I established to perpetuate the original location of this corner:

SEE REVERSE SIDE

FORM 985 H. C. MILLER CO., MILWAUKEE

43109360000

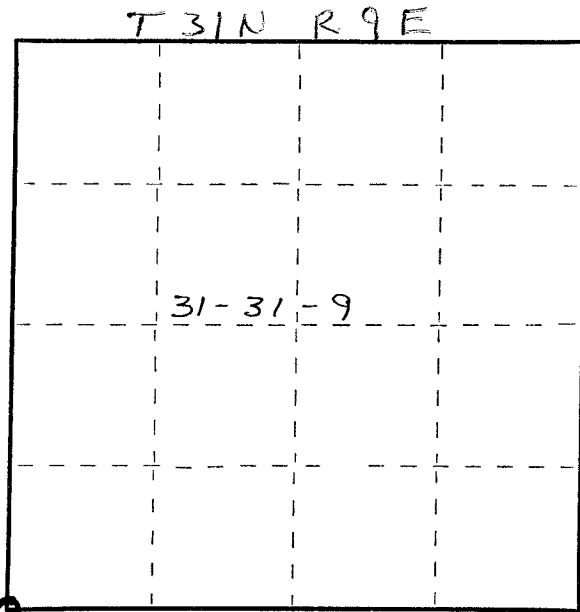

○ = Corner monument restored.

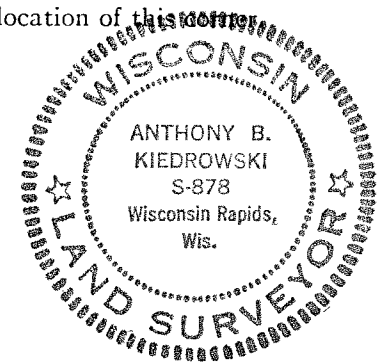

Dated at Wis. Rapids, Wis., this 9th day of December, 1977

Signature AB Kiedrowski Title CLS Registration No. S-878
(County Surveyor, Registered Land Surveyor, or other duly authorized official)

Office of Register of Deeds, County of Langlade, I hereby certify that the within instrument was filed in this office for record on the day of, 19..... at o'clock M.

.....
(Register of Deeds)

By..... Deputy

