

4 30 12 33 0000

U.S. PUBLIC LAND SURVEY MONUMENT RECORD

HISTORY OF ORIGINAL CORNER ESTABLISHMENT AND SUBSEQUENT RESTORATION, AND DESCRIPTION OF ANY RECORD, MONUMENT OCCUPATIONAL, TESTIMONIAL OR OTHER EVIDENCE CONSIDERED:

The original corner was established in 1853 by William J Neely. Original bearing trees: Elm 8" N46W 28lks., Hemlock 10" N40E 42 lks., Hemlock 12" S65E 29lks., Hemlock 10" S15W 28lks. In the early 1900's, Hutchinson set 40 corners in the SE Quarter of Section 33, but makes no mention of this Corner. On Feb 7, 2002, Dan Higginbotham and Gerry Bahar found an 8" Boulder with a chiseled "+" at a fence intersection, and used it as the SW Corner of Section 34-T30N-R12E. Langlade and Shawano County Surveyors have no record of how the Boulder with the Chiseled "+" was set at the Corner. CORNER WAS: (CHECK ALL THAT APPLY)

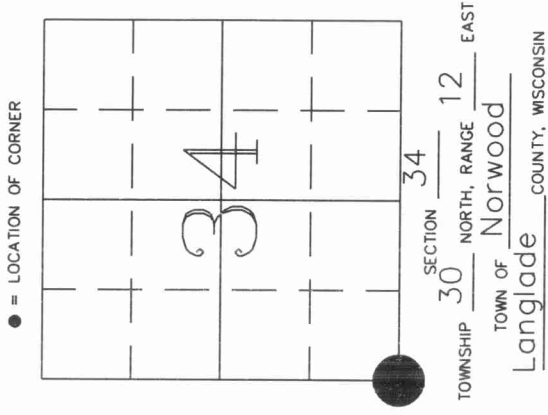

- RESTORED THROUGH ACCEPTANCE OF AN OBLITERATED EVIDENCE LOCATION
- RESTORED THROUGH ACCEPTANCE OF A FOUND PERPETUATED LOCATION
- CONSIDERED A LOST CORNER AND REESTABLISHED THROUGH LOST CORNER PROPORTIONATE METHODS (INCLUDE A PLAN VIEW DRAWING SHOWING DISTANCES AND DIRECTIONS TO OTHER PUBLIC LAND SURVEY CORNERS USED FOR PROPORTIONING AND DETERMINING THE CORNER LOCATION)
- RESTORED OR REESTABLISHED IN A LOCATION THAT DIFFERS FROM A PREVIOUS RESTORATION OR REESTABLISHMENT (INCLUDE A PLAN VIEW DRAWING AND INDICATE WHAT WAS SET AND/OR FOUND)
- CHECK IF THERE IS ADDITIONAL INFORMATION ON BACK

DESCRIBE THE MONUMENT AND ACCESSORIES USED TO PERPETUATE THE LOCATION OF THE CORNER. (INCLUDE A PLAN VIEW DRAWING AND INDICATE WHAT WAS SET AND/OR FOUND) ALSO INCLUDE FOUR TIES TO THE SECTION CORNER AND DESCRIPTION OF THE TIES.

Corner is 200' +/- West of Edge of Field and 70' +/- East of Huge 25' diameter Boulder Split in Half

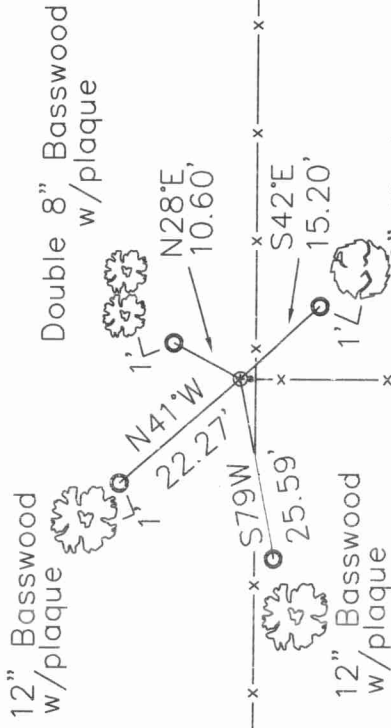

⊕ Fd 8" Boulder with Chiseled Cross 1' North of Fence Corner

○ Set 1"x30" Pipes at Ties

⊙ Set 1"x30" Rebar .50' South of Chiseled Boulder

DANIEL E. HIGGINBOTHAM

(Type or print name) CERTIFY THAT THE CORNER LOCATION SHOWN ON THIS RECORD WAS DETERMINED BY ME OR UNDER MY DIRECTION AND CONTROL AND THAT THIS U.S. PUBLIC LAND SURVEY MONUMENT RECORD IS CORRECT AND COMPLETE TO THE BEST OF MY KNOWLEDGE AND BELIEF.

Dan Higginbotham
SIGNATURE

3/19/02
DATE

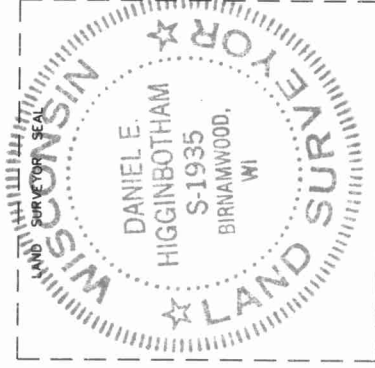

213 30-12

INDEX NO.